

INSTALLATION OF WHISPER PULLEYS

Product No. AS211 WHISPER ARM PULLEY W/WRENCH

1.0 OVERVIEW

This kit is for replacing pulleys on:

AS051 WHISPER ARM SHORT

AS052 WHISPER ARM LONG

See Figure 1. Do not use this kit for A011 or A012 ENGINE ARMS

2.0 MATERIALS

AS211 WHISPER ARM PULLEY W/WRENCH

3.0 PULLEY REMOVAL

3.1 Unplug the power cord and remove the belt.

3.2 Insert the pulley wrench (7/64" diameter rod) into the hole behind the pulley and turn the pulley counterclockwise (as you face the flat side of the pulley). See Figure 2. You will have to remove the pulley wrench and insert it into the opposite hole every half turn.

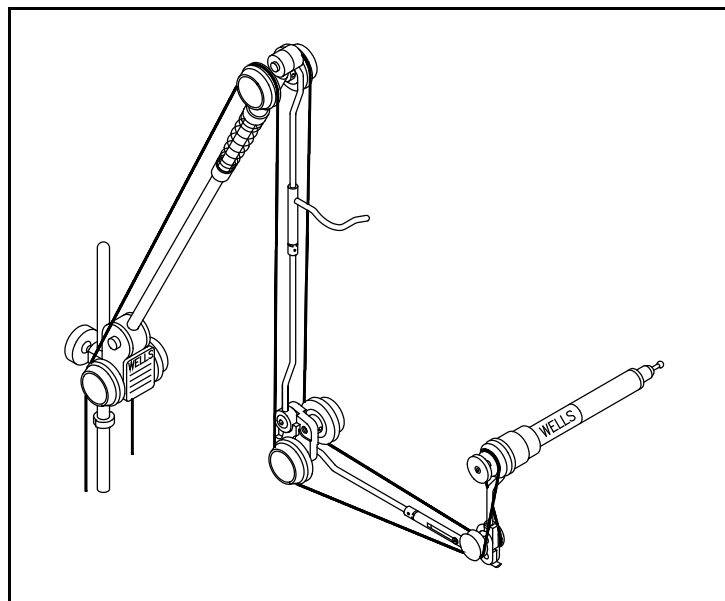

Figure 1.

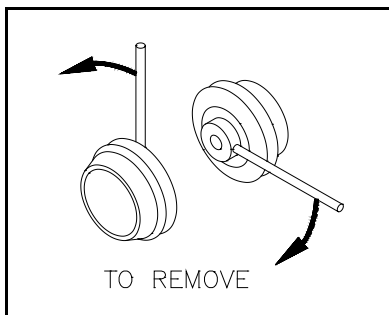

Figure 2.

4.0 INSTALLATION

4.1 Start the pulley onto the threaded stud. Insert the pulley wrench (7/64" diameter rod) into the hole behind one pulley. Turn the pulley clockwise (as you face the flat side of the pulley). See Figure 2. You will have to remove the pulley wrench and insert it into the opposite hole every half turn.

4.2 Make sure the pulleys are tight.

4.3 Install the belt and connect the power cord.