

INSTALLATION OF R127 3 JAW CHUCK RIGHT HAND ON A 1/2" STRAIGHT SHAFT

Product No. R127

1.0 OVERVIEW

The **R127 3 Jaw Chuck Right Hand** is to be installed on a 1/2" **Straight Shaft Right Hand Side Only**.

The **R127 3 Jaw Chuck Right Hand** comes with (2) 10-32 X 1/4" Set Screws and (1) 3/32" Hex Wrench.

2.0 INSTALLATION

- 2.1 Unplug the power cord.
- 2.2 Remove any object from the **Right Hand** shaft.
- 2.3 Make sure the shaft is free from damage or rust.
- 2.4 Make sure the **R127 3 Jaw Chuck Right Hand** slides freely on to the shaft. Do not force it on. If it will not go on there is damage, such as a burr or rust on the shaft. Use a file and/or emery paper (sand paper) to clean the shaft.

- 2.5 If you have a shaft as in **Figure 1**, you **Must File Two (2) Flat Spots** for the **Set Screws to Set On** or the **Set Screws Will Damage the Shaft** and you will not be able to remove the **R127 3 Jaw Chuck Right Hand**. Slide the **R127 3 Jaw Chuck Right Hand** onto the shaft and gently tighten the **Set Screws** to make marks on the shaft. File flats on the shaft where the **Set Screws** made the marks.

- 3.0 If you have a shaft as in **Figure 2**, slide the **R127 3 Jaw Chuck Right Hand** onto the shaft and tighten the two (2) **Set Screws** onto the flat of the shaft.

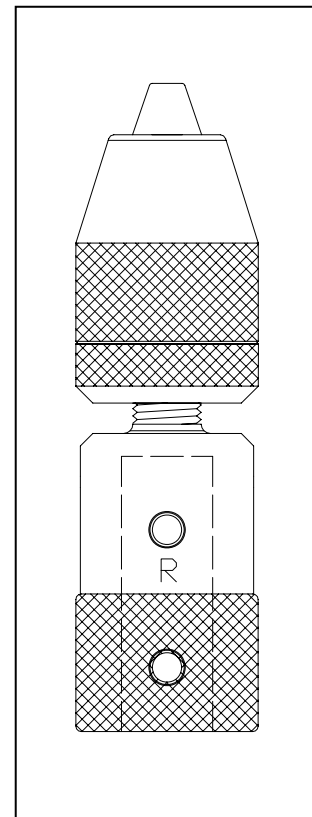

**R127 3 Jaw Chuck
Right Hand**

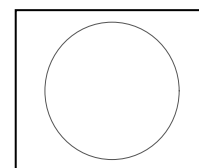

Figure 1

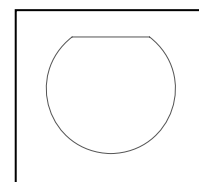

Figure 2

WELLS

DENTAL, INC.

5860 FLYNN CREEK ROAD
P.O. BOX 106
COMPTCHE, CALIFORNIA,
U.S.A. 95427-0106
www.wellsdental.com
sales@wellsdental.com
PHONE (707) 937-0521
1-800-233-0521
FAX (707) 937-2809
1-800-809-7553

PARTS LIST for 3 JAW CHUCK RH 1/2" STRAIGHT SHAFT Product No. R127

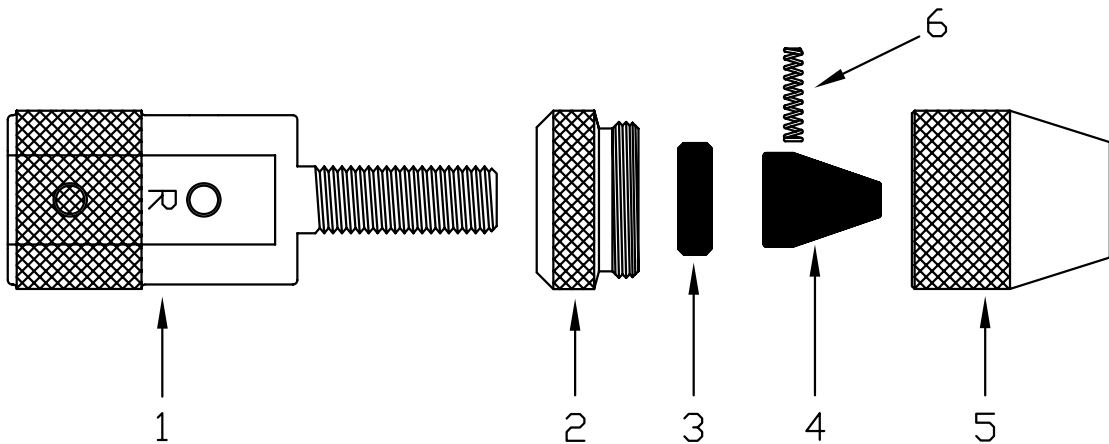
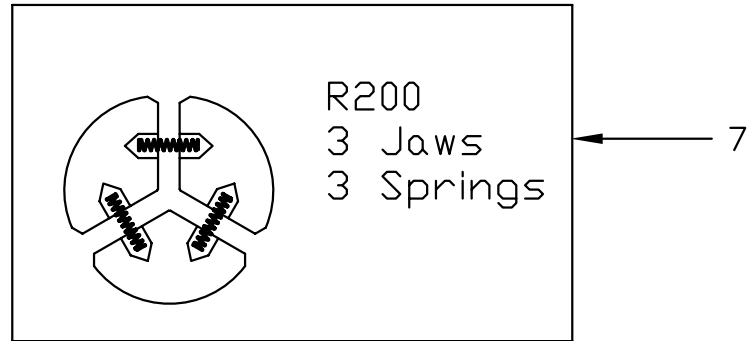

REF.	PART NO.	DESCRIPTION
1	R599	1/2" SHAFT ADAPTER R.H.
2	R593	BACK NUT R.H.
3	R596	PUSH PLATE
4	R598	JAW (Qty 3)
5	R595	NOSE CONE R.H.
6	R597	SPRING (Qty 3)
7	R200	KIT