

INSTALLATION OF R128 3 JAW CHUCK LEFT HAND ON A ½" STRAIGHT SHAFT

Product No. R128

1.0 OVERVIEW

The **R128 3 Jaw Chuck Left Hand** is to be installed on a ½" **Straight Shaft Left Hand Side Only**.

The **R128 3 Jaw Chuck Left Hand** comes with (2) 10-32 X 1/4" Set Screws and (1) 3/32" Hex Wrench.

2.0 INSTALLATION

2.1 Unplug the power cord.

2.2 Remove any object from the **Left Hand** shaft.

2.3 Make sure the shaft is free from damage or rust.

2.4 Make sure the **R128 3 Jaw Chuck Left Hand** slides freely on to the shaft. Do not force it on. If it will not go on there is damage, such as a burr or rust on the shaft. Use a file and/or emery paper (sand paper) to clean the shaft.

2.5 If you have a shaft as in **Figure 1**, you **Must File Two (2) Flat Spots** for the **Set Screws** to **Set On** or the **Set Screws Will Damage the Shaft** and you will not be able to remove the **R128 3 Jaw Chuck Left Hand**. Slide the **R128 3 Jaw Chuck Left Hand** onto the shaft and gently tighten the **Set Screws** to make marks on the shaft. File flats on the shaft where the **Set Screws** made the marks.

3.0 If you have a shaft as in **Figure 2**, slide the **R128 3 Jaw Chuck Left Hand** onto the shaft and tighten the two (2) **Set Screws** onto the flat of the shaft.

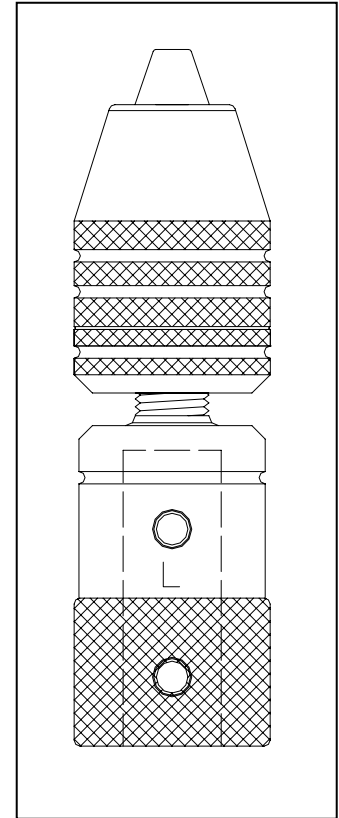

**R128 3 Jaw Chuck
Left Hand**

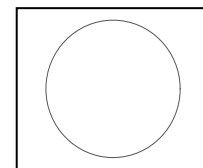

Figure 1

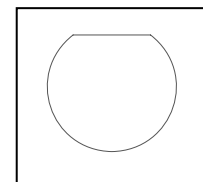

Figure 2

WELLS

DENTAL, INC.

5860 FLYNN CREEK ROAD
P.O. BOX 106
COMPTCHE, CALIFORNIA,
U.S.A. 95427-0106
www.wellsdental.com
sales@wellsdental.com
PHONE (707) 937-0521
1-800-233-0521
FAX (707) 937-2809
1-800-809-7553

PARTS LIST for 3 JAW CHUCK LH 1/2" STRAIGHT SHAFT Product No. R128

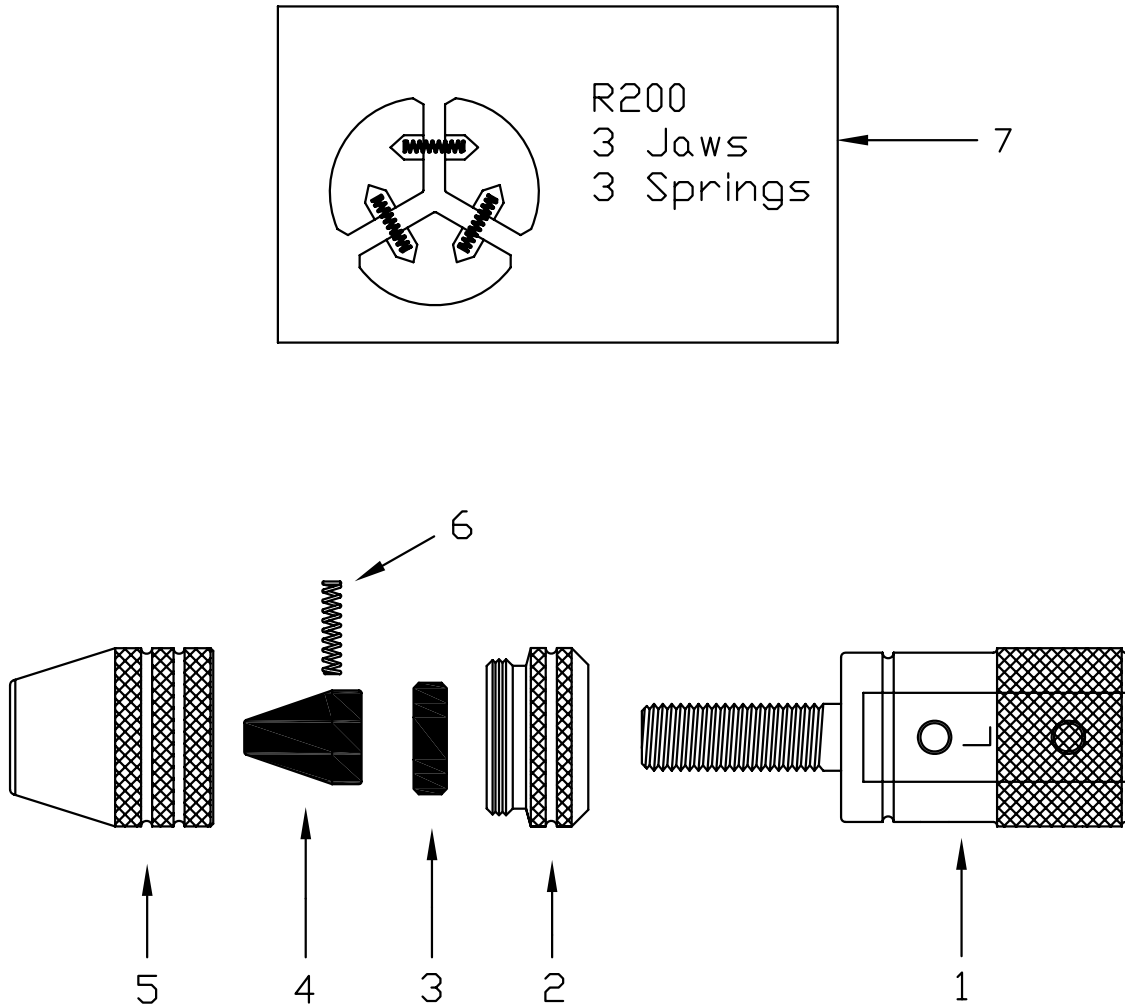

REF.	PART NO.	DESCRIPTION
1	R600	1/2" SHAFT ADAPTER L.H.
2	R592	BACK NUT L.H.
3	R596	PUSH PLATE
4	R598	JAW (Qty 3)
5	R594	NOSE CONE L.H.
6	R597	SPRING (Qty 3)
7	R200	KIT