

WELLS

DENTAL, INC.

5860 FLYNN CREEK ROAD
P.O. BOX 106
COMPTCHE, CA USA
95427-0106
1-707-937-0521 PHONE
1-800-233-0521
1-707-937-2809 FAX
www.wellsdental.com

PARTS LIST for 3 JAW CHUCK RH Product No. R131

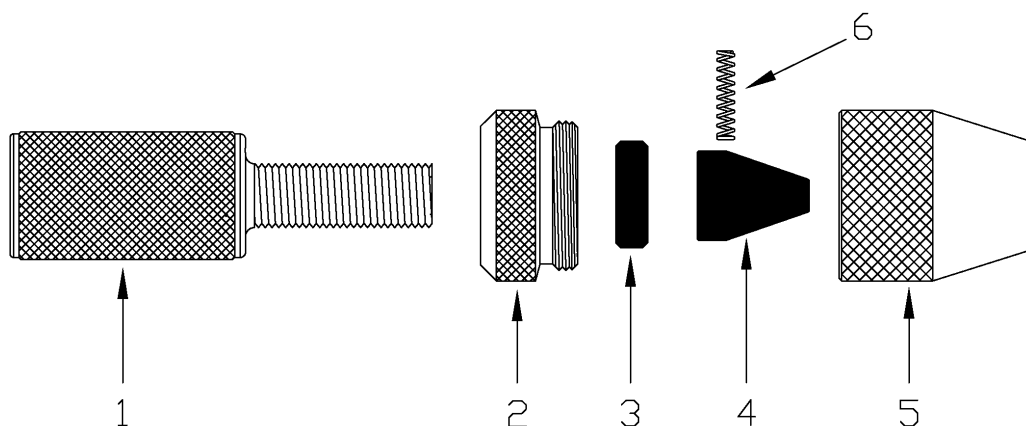
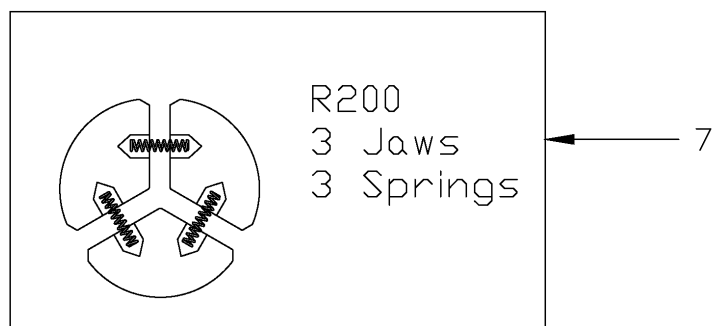

REF.	PART NO.	DESCRIPTION
1	R591	TAPER SHAFT R.H.
2	R593	BACK NUT R.H.
3	R596	PUSH PLATE
4	R598	JAW (Qty 3)
5	R595	NOSE CONE R.H.
6	R597	SPRING (Qty 3)
7	R200	KIT