

ANNUAL CATALOG 2022



Dental Laboratory
Equipment And Supplies



WELLS

DENTAL, INC.

ORDERING & CATALOG INFORMATION

TECHNICAL ASSISTANCE

If you want information about our products or need help to install or service your equipment, please call us. One of our experienced technicians will give you courteous, professional advice.

FACTORY REPAIR SERVICE

Since 1936, Wells Dental's multifaceted factory service program has substantially saved our customers money while restoring the quality of their Wells products. For more information on Wells repair services, see the last section of this catalog.

EQUIPMENT EXCHANGE

If you cannot be without your equipment for the one or two days it takes us to repair your item our exchange service is available. We can send you a rebuilt item with the understanding that you will return your old item to us. Enclosed with the packing list on top of the box you will find a UPS prepaid RS (return service) label. Simply enclose your old equipment in the same box and affix the prepaid return label. You can give the package to any UPS driver and the package will be returned to us. The equipment exchanged will be invoiced at full retail price which serves as a deposit. Upon receipt of your old item, appropriate credit will be issued for the difference between the retail price and the exchange price. No credit will be issued for exchanges not returned within 30 days of invoice date.

PRICE & PRODUCT CHANGES

We reserve the right to change prices, impose purchase restrictions and to make product or engineering changes at any time without prior notification.

Wells Dental today, located in the heart of the California Redwoods.

WARRANTIES

Beginning at the date of purchase, Wells equipment is warranted for the indicated periods and subject to the following conditions:

Limited, 1-year prorated*

New and rebuilt Wells Handpieces
Foot Controls
Super Quick Chucks
High Speed Spindles

1 year — New Engine Unit motors

5 years — New Whisper Arms

All warranties and guarantees are void if the equipment has been oiled or subjected to tampering or abuse. Charges for services by others will not be reimbursed unless previously authorized in writing.

***Prorated**, for terms of all Wells warranties, means:

After 30 days from the date of purchase, one twelfth of the current rebuild price will be charged per month of use up to a maximum of twelve months plus shipping.

RETURN OF GOODS

No return authorization needed. Please ship unused goods in the original packaging and enclose a copy of the invoice. Refund is subject to the condition of the goods, shipping and handling charges. Special orders are not returnable.

ORDERING

Call or fax toll-free... **Hours:**

Phone: 1-800-233-0521 8 AM–4:30 PM
Pacific Time

Fax: 1-800-809-7553

URL: www.wellsdental.com

Mail: Wells Dental, Inc.
PO Box 106
5860 Flynn Creek Rd.
Comptche, CA
95427-0106 USA

PAYMENT

Terms are NET 30 days from date of invoice, on approved credit. A late fee of 1.5% per month (18% annual rate) will be charged on overdue invoices.

We accept MasterCard, Visa, American Express and Discover for advance and C.O.D. orders.



SHIPPING

Items are normally shipped UPS Ground within 24 hours. Shipments are F.O.B. Comptche, CA. They become the responsibility of the customer when the carrier accepts the goods. Inspect the shipment upon arrival and report any damages or shortages directly to the carrier. Although we do our best to meet the delivery dates supplied by our representatives, they do not constitute a guarantee. For estimated delivery time to your location, please inquire when ordering. At your request, we can ship next day (not guaranteed from our location), second day or 3 day UPS delivery.



Quiet soft action, powerful and easy to maintain, Wells engine units set the standard for quality.

Put precise power at your finger tips with a Wells complete laboratory engine unit. Tough stainless steel whisper arms move effortlessly on permanently lubricated ball bearings to ensure the smoothest motion. Choose tough Pyrathane or economical cotton drive belts to deliver the power of 115V or 230V motor to the precision handpiece. The foot control frees your hands for more important tasks.

ENGINE UNIT SPECIFICATIONS

Collet size:	3/32"
Maximum forward speed:	24,000 RPM
Maximum reverse speed:	20,000 RPM
Electrical rating:	115 V, 60 Hz, single-phase, 1.9 Amp*
Shipping weight:	21 lbs
*Also available:	230V, 60 Hz, single-phase, 1.0 Amp



U900 Engine Unit Gray Long Arm **\$1434.00**
 • Hammered gray painted hood

U903 Engine Unit Chrome Long Arm **N/A**
 • Chrome plated hood

U901 Engine Unit Gray Short Arm **1434.00**
 • Hammered gray painted hood

U904 Engine unit Chrome Short Arm **N/A**
 • Chrome plated hood

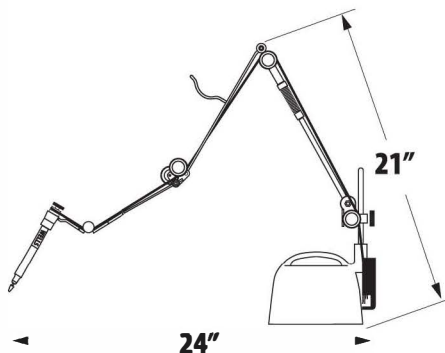
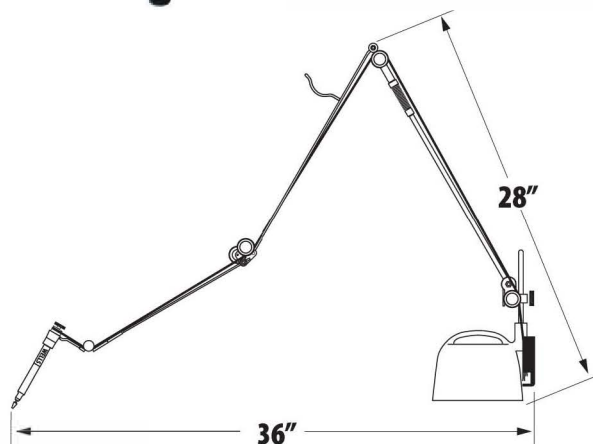

LABORATORY HANDPIECE & WRIST JOINT

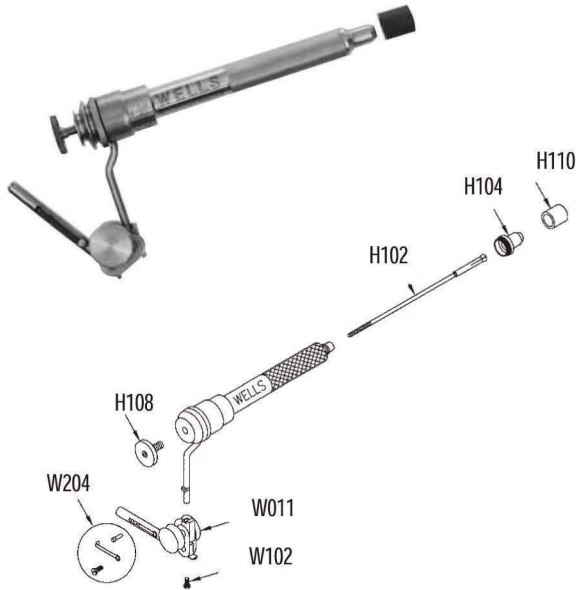

H010	Handpiece with Wrist Joint	\$450.00
	• Permanently lubricated ball bearings	
	• Stainless steel body	
	• Precision collet	

REPLACEMENT PARTS

H108	Thumbscrew	\$19.00
H102	Collet	\$28.00
H104	Nose Cone	\$11.00
H106	Nose Cone Contra Angle	\$15.00
H110	Rubber Wrench	\$3.00
H206	Collet & Thumbscrew	\$43.00
H208	Nose Cone with Rubber Wrench	\$12.00
W011	Wrist Joint	\$166.00
W204	Spring Clip Kit	\$8.00
W102	Retaining Screw Pkg-2	\$5.00

FOOT CONTROL & REPLACEMENT PARTS



For replacement parts not listed in this catalog, please refer to your User's Manual or give us a call.

F011	Foot Control 115V	\$330.00
F013	Foot Control 230V	\$336.00

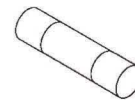

F109	Fuse 5A/250V — Pkg of 2	\$4.00
-------------	-------------------------	---------------

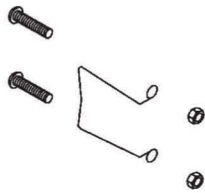

F113	Plug Retainer Kit	\$8.00
-------------	-------------------	---------------

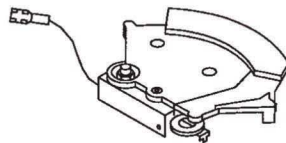

F200	Circuit Board Kit	\$162.00
-------------	-------------------	-----------------

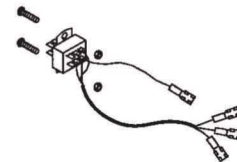

F202	Connector 6-prong male	\$23.00
-------------	------------------------	----------------

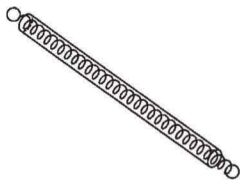

F206	Return Spring Kit	\$17.00
-------------	-------------------	----------------

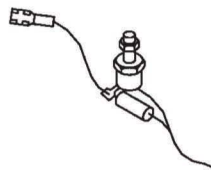

F208	Semiconductor Kit	\$43.00
-------------	-------------------	----------------

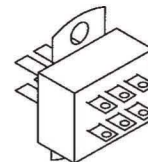

F506	Male Connector	\$12.00
-------------	----------------	----------------

ENGINE ARMS

- | | | |
|--------------|---------------------------------------------------------------------------------------------------------------------------------------------------------------------------------------------------------------------------------------------------------------------------------------------|-----------------|
| AS052 | Whisper arm long | \$420.00 |
| AS051 | Whisper arm short
<ul style="list-style-type: none"> • 302 stainless spring steel construction of small diameter arms and hook • 303 stainless steel construction of large diameter arm, post, block and pulleys • Permanently lubricated ball bearings | \$420.00 |

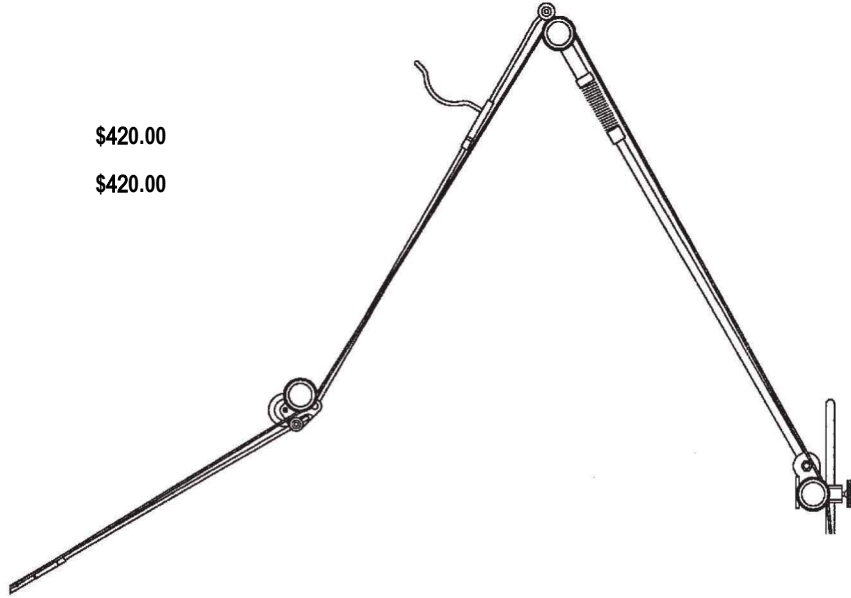

ARM PULLEYS

- | | | |
|--------------|---------------------------------------------------------------------------------------------------------------------------------------------------------------------------------|----------------|
| AS211 | Whisper arm pulley w/wrench
<ul style="list-style-type: none"> • Stainless steel construction • For AS051 (short) and AS052 (long) Whisper Arms only | \$54.00 |
| A106 | Aluminum pulley w/wrench
<ul style="list-style-type: none"> • For A011 (Piccolo) and A012 (Standard) | \$42.00 |

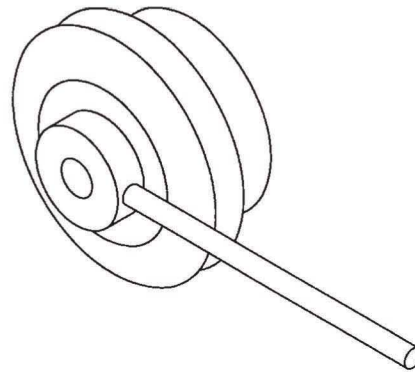

BELTS

- | | | | | | |
|--------------|--------------------------------------------------------------------------------------------------------------------------------------|----------------|-------------|----------------------------------------------------------------------------------------------------------------------------------------------|----------------|
| AS404 | Pyrrathane belt 6' 6"
<ul style="list-style-type: none"> • For AS051 Whisper Arm Short and A011 Engine Arm Piccolo | \$17.00 | A400 | Cotton belt 6' 6" — Pkg. of 2
<ul style="list-style-type: none"> • For AS051 Whisper Arm Short and A011 Engine Arm Piccolo | \$22.00 |
| AS406 | Pyrrathane belt 9' 8"
<ul style="list-style-type: none"> • For AS052 Whisper Arm Long and A012 Engine Arm Standard | \$17.00 | A402 | Cotton belt 9' 8" — Pkg. of 2
<ul style="list-style-type: none"> • For AS052 Whisper Arm Long and A012 Engine Arm Standard | \$22.00 |

ENGINE UNITS & COMPONENTS

HOOD & MOTOR



Shown with hammered gray painted hood.

- E026** Hood & Motor Chrome 115V
 - 115 V, 60 Hz, Single-phase, 1.9 A motor
 - Chrome plated hood**NA**
- E027** Hood & Motor Gray 115V
 - 115 V, 60 Hz, Single-phase, 1.9 A motor
 - Hammered gray painted hood**\$549.00**
- E028** Hood & Motor Chrome 230V
 - 230 V, 60 Hz, Single-phase, 1.0 A motor
 - Chrome plated hood**NA**
- E029** Hood & Motor Gray 230V
 - 230 V, 60 Hz, Single-phase, 1.0 A motor
 - Hammered gray painted hood**\$510.00**

MOTOR, BRUSHES & REPAIR PARTS



- E 132** Motor 115V **\$369.00**
- E 133** Motor 230V **\$369.00**

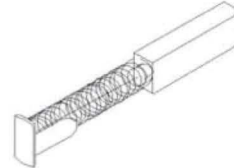

- E101** Brushes Baldor Motor — Pkg. of 2
 - 1/8" x 3/16" x 5/8" (3.17mm x 4.76mm x 15.87mm)
 - For E132 Baldor Motor**\$22.00**

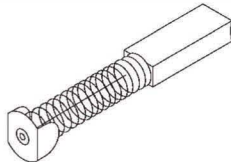

- E105** Brushes Bodine Large — Pkg. of 2
 - 1/4" x 3/8" x 1" (6.35mm x 9.53mm x 25.4mm)
 - For Large Brush E131 Motor**\$22.00**

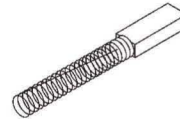

- E107** Brushes Bodine Small — Pkg. of 2
 - 3/16" x 1/4" x 11/16" (4.76mm x 6.35mm x 17.46mm)
 - For Small Brush E129 and E130 Motor**\$22.00**

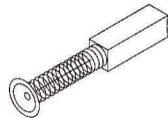

- E106** Brushes WSM Motor — Pkg. of 2
 - 1/4" x 1/4" x 3/4" (6.35mm x 6.35mm x 19.05mm)
 - For WSM motors (manufactured before Oct. 1983)**\$22.00**

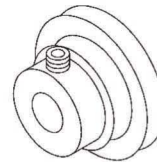

- E150** Motor Pulley with Set Screw **\$19.00**

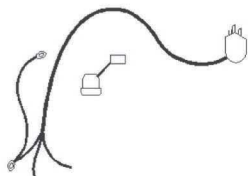

- E112** Power Cord Kit **\$23.00**

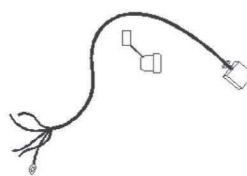

- E110** 5-wire Cord Kit **\$47.00**

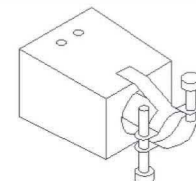

- E504** Connector 6-prong Female **\$22.00**

For replacement parts not listed in this catalog, please refer to your User's Manual or give us a call.

Quiet operation. Fully adjustable for comfort. Jewelers taper on the left hand side.

GOLD CHROME FINISHING MACHINE

U712 Gold Chrome Machine 115V Hz 60Hz **\$1839.00**

- Wells High Speed Spindle Quick tool changes while lathe is running
- Wells Light Shield with tempered glass
- Wells 115 Volt, 1/3 Hp lathe
- Collet size: standard 3/32" (1/16", 1/8" or 3mm collets are available)
- Spindle RPM: 12000 (low) and 24000 (high)
- Lathe RPM: 1725 (low) and 3450 (high)
- Electrical rating: 115 Volt, 60 Hz, single phase, 3.3 Amp
- Shipping weight: 55 lbs.

Also available with 100 volt or 230 volt lathe. 50 Hz or 60 Hz

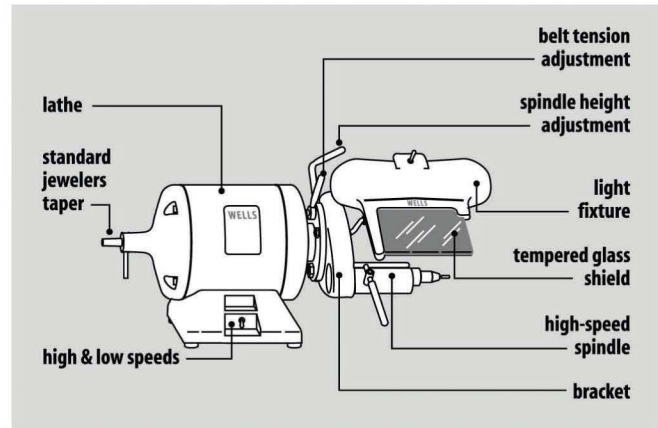
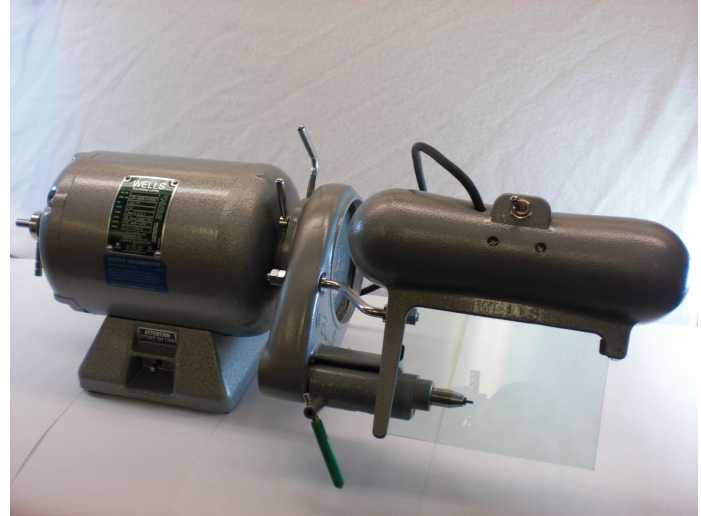

GOLD CHROME BRACKET ASSEMBLY /RW

U011 Gold Chrome Bracket Assembly/RW **\$959.00**

- Without lathe for field installation on a Red Wing Lathe
- Collet size: standard 3/32" (1/16", 1/8" or 3mm collets are available.)
- Shipping weight: 9lbs.



WELLS HIGH SPEED SPINDLES FOR DEMCO & TICONIUM HIGH SPEED ALLOY GRINDERS, BELT DRIVEN

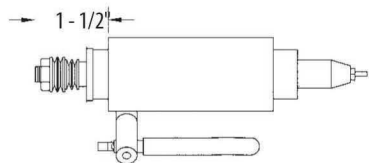

- S020** For Demco E96 High Speed Alloy Grinder **\$396.00**
- Standard shaft length
 - S116 with two pulley diameters for double vee belt
 - S141 Pulley Shield
 - Two 10-32 threaded mounting holes

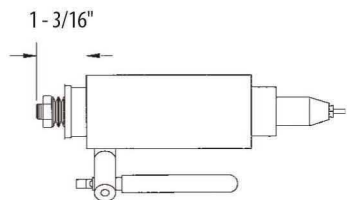

- S021** For Demco and Ticonium High Speed Alloy Grinders **\$396.00**
- Short Shaft
 - S118 with one pulley diameter for double vee belt
 - S141 Pulley Shield
 - Two 10-32 threaded mounting holes

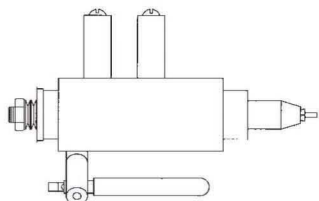

- S018** For Demco B1 High Speed Alloy Grinder **\$396.00**
- Short shaft
 - S118 with one pulley diameter for double vee belt
 - S141 Pulley Shield
 - S230 Smooth Mounting Tubes

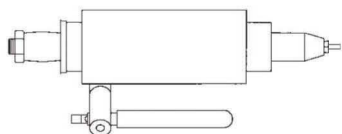

- S019** For Demco High Speed Alloy Grinder **\$396.00**
- S120 Pulley for flat belt
 - S141 Pulley Shield
 - Two 10-32 threaded mounting holes

WELLS HIGH SPEED SPINDLES FOR BEGO & NIRANIUM HIGH SPEED ALLOY GRINDERS

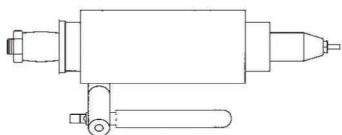

- S036** For Bego High Speed Alloy Grinder **\$396.00**
- S120 Pulley for flat belt
 - S141 Pulley Shield
 - Four 6mm threaded mounting holes

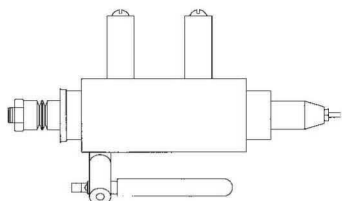

- S042** For Niranium High Speed Alloy Grinder **\$396.00**
- S136 Pulley for double vee belt
 - S141 Pulley shield
 - S230 Smooth Mounting Tubes

FINISHING MACHINES & COMPONENTS

HIGH SPEED SPINDLES FOR WELLS GOLD CHROME FINISHING MACHINES

- S013** For Wells Gold Finishing Machine
- S114 Pulley for double vee belt
 - Two 10-32 threaded mounting holes

\$396.00

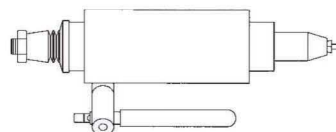

- S012** For Wells Gold Chrome "I" Finishing Machine on Red Wing Lathe
- S114 Pulley for double vee belt
 - S240 Threaded Mounting Tubes

\$396.00

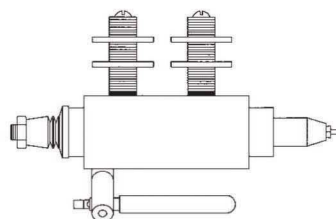

- S011** For Wells Gold Chrome "I" Finishing Machine on Red Wing Lathe
- S120 Pulley for flat belt
 - S141 Pulley Shield
 - S240 Threaded Mounting Tubes

\$396.00

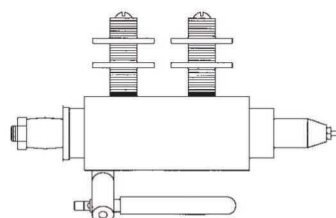

WELLS HIGH SPEED SPINDLES FOR FOSTER ALLOY GRINDERS

- S030** For Foster series III, 5A and AG04/CF Price/Whip Mix High Speed Alloy Grinder
- S134 two pulley diameters for triple vee belt
 - S519 (small) .687"-17.45mm:
 - S520 (large) 1.370"-34.80mm
 - S230 Smooth Mounting Tubes

\$396.00

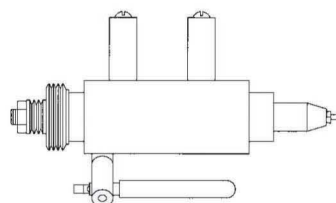

- S031** For Foster series AG03 and AG05 (variable speed)
- S135 two pulley diameters for triple vee belt
 - S521 (small) black anodized .587"-14.92mm:
 - S522 (large) black anodized 1.268"-32.20mm
 - S230 Smooth Mounting Tubes

\$396.00

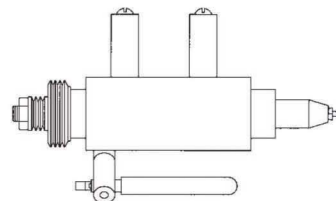

- S028** For Foster Flat Belt High Speed Alloy Grinder
- S130 and S132 two pulley diameters for flat belt
 - S141 Pulley Shield
 - S230 Smooth Mounting Tubes

\$396.00

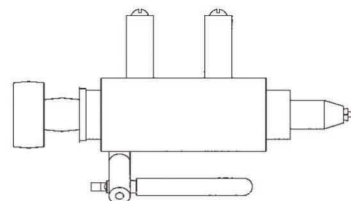

- S029** For Foster series PE3 and PEA High Speed Alloy Grinder
- S130 and S128 two pulley diameters for a flat belt
 - S141 Pulley Shield
 - Housing for clamp type mounting

\$396.00

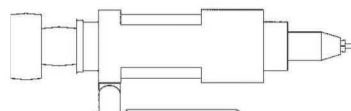

WELLS HIGH SPEED SPINDLE REPLACEMENT PARTS



Wells High Speed Spindles can be ordered to fit most alloy grinders. Please consult pages 10 & 11 for ordering information or call us for help. All spindles are shipped with S250 Accessory Kit and Users Manual.

See page 13 for mounting hardware.
See page 14 & 15 for pulleys.
See page 16 for belts.

S152	Stop Tubes set of 6	\$14.00
	Stop Tube .245 Blue	\$4.00
	Stop Tube .255 Yellow	\$4.00
	Stop Tube .265 Orange	\$4.00
	Stop Tube .275 Red	\$4.00
	Stop Tube .285 Green	\$4.00
	Stop Tube .295 Black	\$4.00
S106	Collet 3/32	\$21.00
S105	Collet 1/16	\$26.00
S108	Collet 3mm	\$25.00
S110	Collet 1/8	\$25.00
138	Shipping Rod 3/32	\$2.00
S551	Pulley Jam Nut	\$5.00
S36	Screw Set 10-32 x 3/16	\$1.50
S154	Collet Wrench 3 Jaw	\$12.00
S155	Collet Wrench 4 Jaw	\$12.00
S159	Collet Wrench 1/16	\$12.00
S161	Collet Wrench 3mm & 1/8	\$12.00
S112	Handle Kit	\$14.00
S545	Handle only no grip	\$12.00
S546	Grip 2-3/8"	\$3.00
S250	Accessory Kit	\$29.00
151	Hex Wrench 3/32	\$3.00
159	Hex Wrench 1/8	\$3.00
S152	Stop Tubes set of 6	\$14.00
S153	Stop Remove Tool	\$15.00
S165	Tube Brush 3/16	\$6.00
S551		
S36		
S154		
S155		
S159		
S161		
S545		
S546		
151		
159		
S152		
S153		
S165		

FINISHING MACHINES & COMPONENTS

SPINDLE MOUNTING HARDWARE FOR WELLS HIGH SPEED SPINDLES

S220

Spindle Mounting Kit

- Fastens S013 Wells High Speed Spindle to Wells Gold Chrome Finishing Machines: U011, U015, U020, U711 & U712

\$15.00

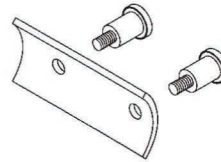

S230

Mounting Tube Smooth - Pkg of 2

- Fastens S018, S028, S030, S031 & S042 Wells High Speed Spindles to Demco B1, Foster and Niranium Grinders

\$18.00

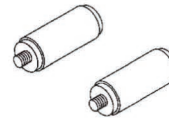

S231

Smooth Tube Rebuild Kit

\$4.00

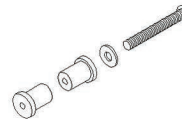

S240

Mounting Tube Threaded - Pkg of 2

- Fastens S011 or S012 Wells high speed spindles to older Wells Gold Chrome "I" finishing machines

\$48.00

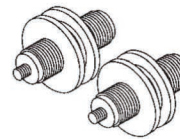

S241

Threaded Tube Rebuild Kit

\$8.00

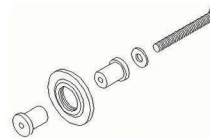

FINISHING MACHINES & COMPONENTS

See pages 10 and 11 for pulley configurations.

SPINDLE PULLEYS FOR HIGH SPEED ALLOY GRINDING MACHINES



S141 Pulley Shield
 • For all pulleys except S114, S134 & S135

\$14.00

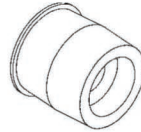

S128 Pulley for S029
 • Fits Foster PE3 & PEA
 • Fits older Foster Alloy Grinders with flat belt

\$12.00

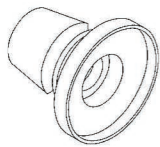

S114 Pulley for S012/S013
 • Fits double v belt
 • Fits Wells Gold Chrome Finishing Machines
 • Fits Wells Gold Chrome "I" with double v belt

\$16.00

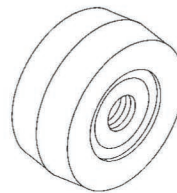

S130 Pulley for S028/S029
 • Low speed aluminum pulley
 • Fits Foster PE3 & PEA
 • Fits Foster Alloy Grinders with flat belt
 • This pulley also threads onto the spindle shaft and holds on the S128 pulley above and the S132 pulley below

\$12.00

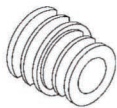

S116 Pulley for S020
 • For double v belt
 • 2 pulley diameters
 • Fits Demo E96 (standard shaft length)

\$12.00

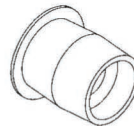

S132 Pulley for S028
 • Fits Foster Alloy Grinders with flat belt

\$12.00



S118 Pulley for S018/S021/S049
 • For double v belt
 • 1 pulley diameter
 • Fits Demco (short shaft), Demco B1 & Ticonium

\$16.00



S134 Pulley for S030
 • For triple v belt
 • Set of 2 pulleys;
 S519 (small) .687" - 17.45mm:
 S520 (large) 1.370" - 34.80mm
 • Fits Foster Series III & AG04 Alloy Grinders

\$16.00

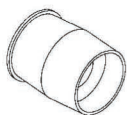

S120 Pulley for S011/S019/S036
 • Fits Bego (Germany) and Demco Alloy Grinders with flat belt
 • Fits older Wells Gold Chrome "I" with flat belt

\$12.00



S135 Pulley for S031
 • For triple v belt
 • Set of 2 pulleys;
 S521 (small) black Anodized .587" - 14.92mm:
 S522 (large) black Anodized 1.268" - 32.20mm
 • Fits Foster Series AG03 and AG05 (variable speed)

\$16.00

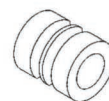

S136 Pulley for S042/S043
 • For double v belt
 • Fits Niranium Alloy Grinders

\$12.00

MOTOR PULLEYS FOR HIGH SPEED ALLOY GRINDING MACHINES



S480 Motor Pulley 2V-V/Wells
 • 4-3/8" dia, flat edged pulley for double v belt
 • For 1/2-20 threaded motor shaft
 • Fits Wells R055, R056, R057 or R058 lathe with Wells Gold Chrome Finishing Machine U712

\$46.00

S492 Motor Pulley 2V-2SP-2V/D/T
 • 2 steps 3" and 3-1/2" dia, double v pulley
 • For 1/2" dia motor shaft
 • Fits Demco, Ticonium Alloy Grinders

\$63.00

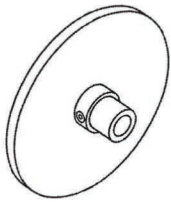

S482 Motor Pulley 2V-V/B/RW
 • 4-3/8" dia, flat edged pulley for double v belt
 • For 1/2" dia motor shaft
 • Fits Red Wing Lathe with Wells Gold Chrome Finishing Machine

\$46.00

S494 Motor Pulley Flat 2SP RS CT/F
 • 2 steps 3-7/8" dia, crowned pulley for flat belt
 • For 1/2" dia motor shaft
 • Fits Foster Alloy Grinders with flat belt

\$63.00

S484 Motor Pulley Flat Crown/RW
 • 3-7/8" dia, crowned pulley for flat belt
 • For 1/2" dia motor shaft
 • Fits Red Wing Lathe with older Wells Gold Chrome "I" with flat belt

\$63.00

S495 Motor Pulley Flat 3-1/2" Dia
 • 3-1/2" dia, crowned pulley for flat belt
 • For 1/2" dia motor shaft
 • Fits Demco Alloy Grinders with flat belt

\$63.00

S486 Motor Pulley Flat Crown/W/B
 • 3-7/8" dia, crowned pulley for flat belt
 • For 1/2" dia motor shaft
 • Fits Baldor lathe with older Wells Gold Chrome "I" with flat belt

\$63.00

S496 Motor Pulley Flat 3-3/4" Dia
 • 3-3/4" dia, crowned pulley for flat belt
 • For 1/2" dia motor shaft
 • Fits Demco Alloy Grinders with flat belt

\$63.00

S490 Motor Pulley 2V-2V/D/TIC/NIR
 • 3-1/2" dia, double v pulley
 • For 1/2" dia motor shaft
 • Fits Demco, Ticonium and Niranium Grinders

\$63.00

S498 Motor Pulley 1V2SP/Demco
 • 2 steps 3-1/8" and 3-3/8" dia, single v pulley
 • For 1/2" dia motor shaft
 • Fits Demco Alloy Grinders

\$63.00

FINISHING MACHINES & COMPONENTS

V BELTS FOR HIGH SPEED ALLOY GRINDING MACHINES

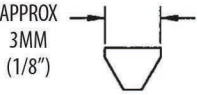
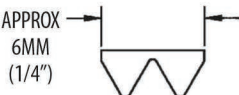
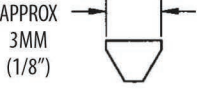
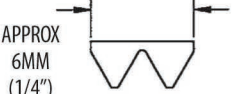
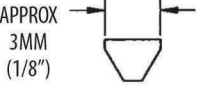
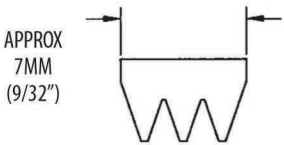
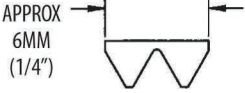
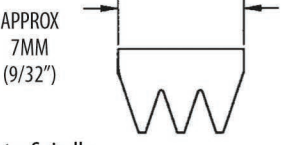
<p>S400 Belt 3M462</p> <ul style="list-style-type: none"> • Single v, 462mm (18-3/16") circumference • For Demco Low Speed Alloy Grinder 	 <p>APPROX 3MM (1/8")</p>	<p>\$19.00</p>	<p>S408 Belt 2/3M487J</p> <ul style="list-style-type: none"> • Double , 487mm (19-3/16") circumference • For Demco E96 (high speed) 	 <p>APPROX 6MM (1/4")</p>	<p>\$35.00</p>
<p>S402 Belt 3M475</p> <ul style="list-style-type: none"> • Single v, 475mm (18-11/16") circumference • For Demco, Baldor, Red Wing and older Wells 	 <p>APPROX 3MM (1/8")</p>	<p>\$19.00</p>	<p>S410 Belt 2/3M500</p> <ul style="list-style-type: none"> • Double v, 500mm (19-11/16") circumference • For Demco 	 <p>APPROX 6MM (1/4")</p>	<p>\$35.00</p>
<p>S404 Belt 3M487</p> <ul style="list-style-type: none"> • Single v, 487mm (19-3/16") circumference • For Demco special 	 <p>APPROX 3MM (1/8")</p>	<p>\$19.00</p>	<p>S412 Belt 3V-21 Foster Vacuum</p> <ul style="list-style-type: none"> • Triple v, 533mm (21") circumference • For Foster Series III & AG04 Vacuum Drive 	 <p>APPROX 7MM (9/32")</p>	<p>\$19.00</p>
<p>S406 Belt 2/3M475JB</p> <ul style="list-style-type: none"> • Double v, 475mm (18-11/16") circumference • For Wells Gold Chrome Finishing U712 Machine, Demco E96 (low speed), Baldor, Red Wing and Niranium 	 <p>APPROX 6MM (1/4")</p>	<p>\$35.00</p>	<p>S414 Belt 3V-24 Foster Spindle</p> <ul style="list-style-type: none"> • Triple v, 610mm (24") circumference • For Foster Series III & AG04 Spindle Drive for CF Price or Whip Mix 	 <p>APPROX 7MM (9/32")</p>	<p>\$19.00</p>

FLAT BELTS FOR HIGH SPEED ALLOY GRINDING MACHINES

<p>S416 Belt Flat 9/16" X 13-1/2"</p>	<p>\$31.00</p>	<p>S428 Belt Flat 9/16" X 18-3/4"</p>	<p>\$31.00</p>
<p>S418 Belt Flat 9/16" X 15"</p>	<p>\$31.00</p>	<p>S430 Belt Flat 9/16" X 19"</p>	<p>\$31.00</p>
<p>S420 Belt Flat 9/16" X 17-1/4</p> <ul style="list-style-type: none"> • For Wells with worn or recrowned pulleys 	<p>\$31.00</p>	<p>S432 Belt Flat 9/16" X 19-1/4</p> <ul style="list-style-type: none"> • For Wells with worn or recrowned pulleys 	<p>\$31.00</p>
<p>S422 Belt Flat 9/16" X 17-1/2"</p> <ul style="list-style-type: none"> • For Wells Gold Chrome "I" or Red Wing Lathe (See S420) 	<p>\$31.00</p>	<p>S434 Belt Flat 9/16" X 19-1/2"</p>	<p>\$31.00</p>
<p>S423 Belt Flat 9/16" X 18"</p>	<p>\$31.00</p>	<p>S436 Belt Flat 9/16" X 19-3/4"</p> <ul style="list-style-type: none"> • For Foster (F) with worn or recrowned pulleys 	<p>\$31.00</p>
<p>S424 Belt Flat 9/16" X 18-1/4"</p> <ul style="list-style-type: none"> • For Demco with worn or recrowned pulleys 	<p>\$31.00</p>	<p>S438 Belt Flat 9/16" X 20"</p> <ul style="list-style-type: none"> • For Foster PE3 & PEA grinder (F) (See S436) 	<p>\$31.00</p>
<p>S426 Belt Flat 9/16" X 18-1/2"</p> <ul style="list-style-type: none"> • For Demco flat belt grinder (See S424) 	<p>\$31.00</p>	<p>S440 Belt Flat 9/16" X 23"</p> <ul style="list-style-type: none"> • For Foster flat belt grinder (FB) 	<p>\$31.00</p>

To order belts

Please furnish the following:

1. Model and manufacturer of the alloy grinder
2. Serial number of the spindle
3. The type of belt (flat belt, 1, 2 or 3 v belt)
4. The circumference of the belt (total length)

To ensure correct belt size

Wrap a cord over the pulley in use and measure the length either in inches or millimeters.

SUPER QUICK CHUCKS MOUNTED ON LATHES, DIRECT DRIVEN



U510 Quick Chuck on 1/3hp lathe 115V 60Hz **\$1479.00**
1725/3450 RPM
For "Heavy Duty" grinding & polishing



U523 Quick Chuck on 1/3hp lathe with Light Shield **\$1629.00**
1725/3450 RPM
For "Heavy Duty" grinding & polishing

R057 Wells 1/3hp Lathe 115V 60Hz **\$1114.00**
1725/3450 RPM
Ready to accept Quick Chuck Q015
Clutch is Installed
For "Heavy Duty" grinding & polishing



U610 Quick Chuck on right & left side on **\$1949.00**
1/3 hp lathe, 115V 60 Hz
1725/3450 RPM
For "Heavy Duty" grinding & polishing



U629 Semi-Perm on right & left side on **\$1662.00**
1/3 hp lathe, 115V 60 Hz
1725/3450 RPM
For "Heavy Duty" polishing

SUPER QUICK CHUCK SPECIFICATIONS

Collet Sizes:	integrated 1/4" and 3/32"	
Operating speeds:	1725 and 3450 RPM	
Unit dimensions:	U510	approx. 8" X 9" X 18"
	U523	approx. 8" X 11" X 24"
Shipping weight::	U510	50 lbs
	U523	52 lbs
Shaft height::	5 1/4"	

Other Lathes & Quick Chuck combinations are available. Please call for more information

SUPER QUICK CHUCKS

If your lathe has never had a quick chuck installed, an adaptor kit is necessary. See pages 23 & 24 for adaptors.



Q015 Super Quick Chuck Right Hand
• Shipped with Q203 accessory kit & users manual **\$396.00**



Q011 Super Quick Chuck Left Hand
• Shipped with Q200 accessory kit & users manual **\$396.00**



Q023 Quick Chuck Semi-Permanent Mounted Spiral RH **\$338.00**



Q019 Quick Chuck Semi-Permanent Mounted Spiral LH **\$338.00**

WELLS SUPER QUICK CHUCK REPLACEMENT PARTS & TOOLS

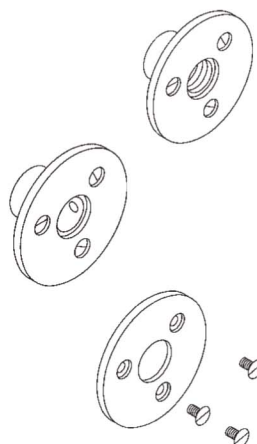
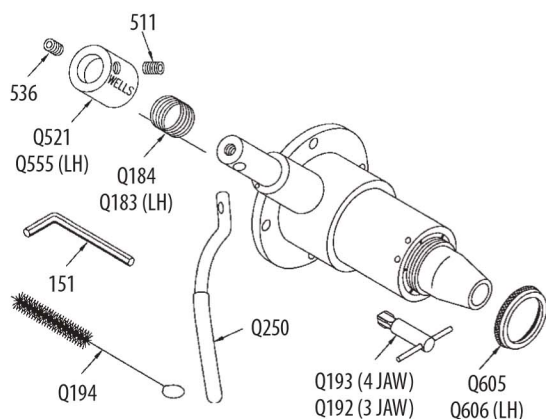
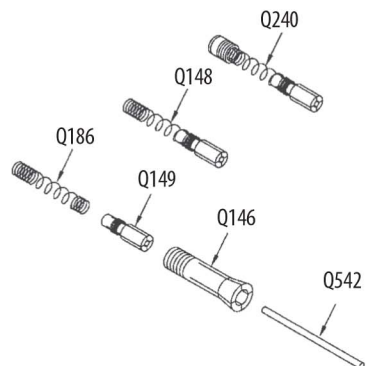
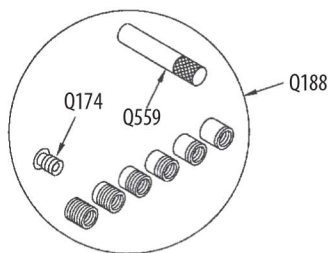

Q188	Stops - set of 6 • With stop lock screw & test rod	\$18.00
Q174	Stop Lock Screws – Pkg. of 2	\$4.00
Q559	Test Rod 1/4" • For fitting a stop to adjust the collet diameter	\$4.00
Q240	Special Collet Complete	\$28.00
Q148	Special Collet With Spring	\$26.00
Q186	Pop-Out Spring – Pkg. of 2	\$5.00
Q149	Special Collet	\$23.00
Q146	Master Collet	\$26.00
Q542	Shipping Rod 3/32" X 2-1/8"	\$2.00
511	Screw set 10-32" x 1/4"	\$1.50
536	Screw Set 10-32" X 3/16"	\$1.50
Q521	Number Cap RH	\$24.00
Q555	Number Cap LH	\$24.00
Q184	Clutch Spring RH	\$13.00
Q183	Clutch Spring LH (<i>painted red</i>)	\$13.00
Q250	Handle with Set Screw	\$15.00
Q605	Dust Cover RH	\$16.00
Q606	Dust Cover LH	\$18.00
151	Hex Wrench 3/32"	\$3.00
Q194	Tube Brush 3/8"	\$6.00
Q193	Collet Wrench 4 Jaw	\$13.00
Q192	Collet Wrench 3 Jaw	\$13.00

Q243	Clutch Wells Threaded Complete • For Quick Chuck on Wells R057 Lathe • Clutch threads onto shaft of lathe	\$41.00
Q246	Clutch Baldor/Red Wing Complete • For Quick Chuck on Baldor or Red Wing • Clutch held on with set screw	\$41.00
Q150	Clutch Lining with Screws • For all Wells Super Quick Chucks	\$22.00

SUPER QUICK CHUCK ACCESSORIES

- Q203** Accessory Kit RH **\$84.00**
- For Q015 Quick Chuck Right Hand
 - Q134 Spiral Chuck RH (1 included in kit)
 - Q126 Arbor Band Chuck 3/4 RH (1)
 - Q154 Mandrel with 1-64 screw RH (2)
 - Q142 Stone Chuck Tooth & Knife RH (2)
 - Q188 Stops - set of 6 (includes Stop Lock Screw and Test Rod)
 - Q194 Tube Brush 3/8
 - Q193 Collet Wrench 4 jaw
 - 151 Hex Wrench 3/32
 - Q169 Installation Screws — Pkg. of 4

See the following illustrations for details of individual accessories.

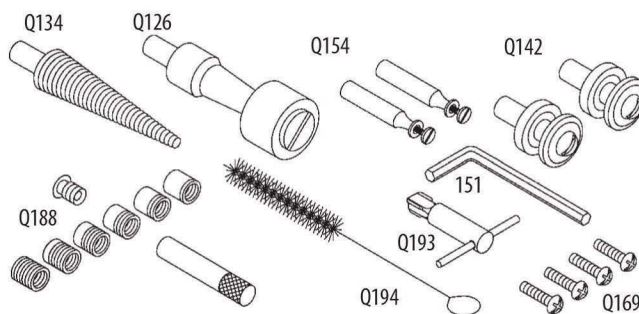

- Q200** Accessory Kit LH **\$94.00**
- For Q011 Quick chuck Left Hand
 - Q132 Spiral Chuck LH (1 included in kit)
 - Q124 Arbor Band Chuck 3/4 LH (1)
 - Q152 Mandrel with 1-64 screw LH (2)
 - Q140 Stone Chuck Tooth & Knife LH (2)
 - Q188 Stops - set of 6 (includes Stop Lock Screw and Test Rod)
 - Q194 Tube Brush 3/8
 - Q193 Collet Wrench 4 jaw
 - 151 Hex Wrench 3/32
 - Q169 Installation Screws — Pkg. of 4

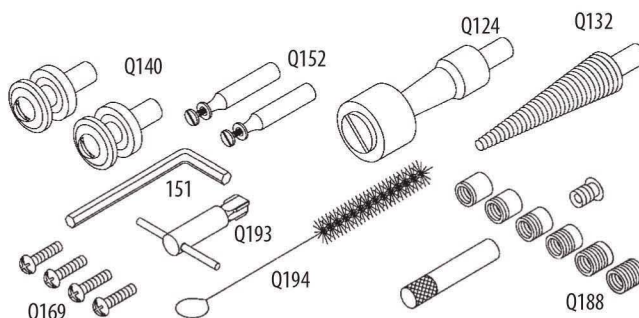

- L013** Light Shield - Quick Chuck RH **\$165.00**
- Light fixture and tempered glass shield
 - Installs with **right hand** Quick Chuck
 - Light bulbs are not included

- L014** Light Shield - Quick Chuck LH **\$180.00**
- Light Fixture and tempered glass shield
 - Installs with **left hand** Quick Chuck
 - Light bulbs are not included

- L110** Glass Shield for Wells **\$23.00**
- Tempered glass for L011, L013 & L014
 - 4" X 6"

- Q104** Collet Shield RH **\$19.00**
- Fits **right hand** Quick Chuck with knurled stainless steel dust cover (ring) only.

- Q103** Collet Shield LH **\$28.00**
- Fits **left hand** Quick Chuck with knurled stainless steel dust cover (ring) only.

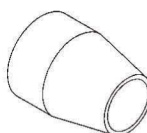
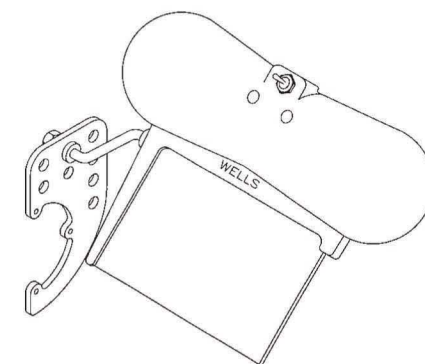

New

This non-rotating collet shield covers the collet body to provide a steady rest for more comfortable operation of your Wells Super Quick Chuck. It also helps protect rubber gloves.

SUPER QUICK CHUCK ACCESSORIES

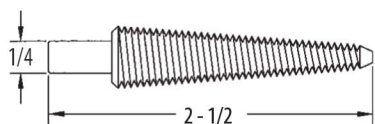

Q134 Spiral Chuck RH
• For brushes and buffs **\$15.00**

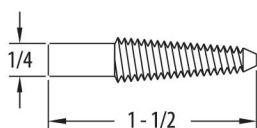

Q132 Spiral Chuck LH
• For use on the left side of the lathe **\$15.00**

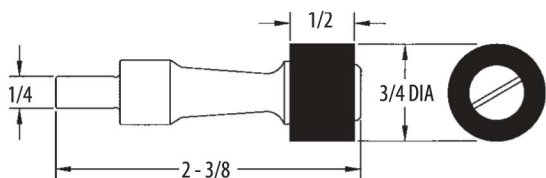

Q131 Spiral Chuck Short RH
• For brushes and buffs **\$15.00**

Q133 Spiral Chuck Short LH
• For use on the left side of the lathe **\$15.00**

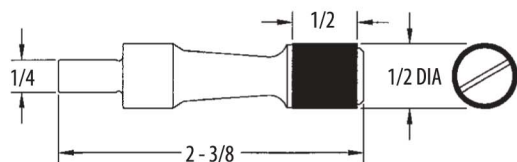

Q126 Arbor Band Chuck 3/4 RH
• Expanding drum for 3/4" dia. abrasive bands **\$15.00**

Q124 Arbor Band Chuck 3/4 LH
• For use on the left side of the lathe **\$15.00**

Q122 Arbor Band Chuck 1/2 RH
• Expanding drum for 1/2" dia. abrasive bands **\$15.00**

Q120 Arbor Band Chuck 1/2 LH
• For use on the left side of the lathe **\$15.00**

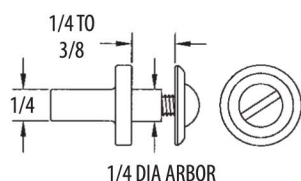

Q142 Stone Chuck Tooth & Knife RH
• For wheels and stones 1/4" to 3/8" thick
• 1/4" dia. arbor **\$15.00**

Q140 Stone Chuck Tooth & Knife LH
• For use on the left side of the lathe **\$15.00**

See pages 27- 40
for consumables

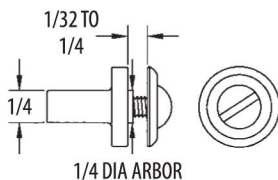

Q138 Stone Chuck Thin Econo RH
• For Econo Cutters, wheels and stones
from 1/32" to 1/4" thick
• 1/4" dia. arbor **\$15.00**

Q136 Stone Chuck Thin Econo LH
• For use on the left side of the lathe **\$15.00**

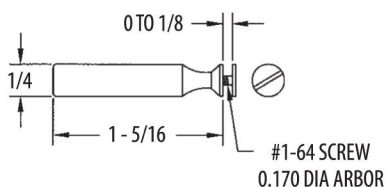

Q154 Mandrel with 1-64 screw RH
• For separating & finishing discs
• For diamond discs & heatless wheels
• 0.170" dia. arbor **\$15.00**

Q152 Mandrel with 1-64 screw LH
• For use on the left side of the lathe **\$15.00**

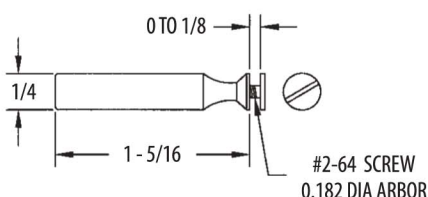

Q158 Mandrel with 2-64 screw RH
• For separating & finishing discs
• For diamond discs & heatless wheels
• 0.182" dia. arbor **\$15.00**

Q156 Mandrel with 2-64 screw LH
• For use on the left side of the lathe. **\$15.00**

SUPER QUICK CHUCK ACCESSORIES

Q106 Burr Adapter 1/16
 • For holding 1/16" dia. shank in 1/4" chuck

\$16.00

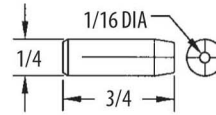

Q108 Burr Adapter 3/32
 • For holding 3/32" dia. shank in 1/4" chuck

\$16.00

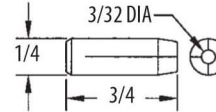

Q110 Burr Adapter 1/8
 • For holding 1/8" dia. shank in 1/4" chuck

\$16.00

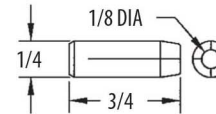

Q112 Burr Adapter 3MM
 • For holding 3mm dia. shank in 1/4" chuck

\$16.00

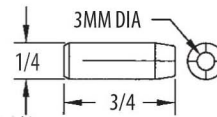

Q130 Sandpaper Chuck
 Slotted mandrel for holding sandpaper roll
 • Roll is held in place with waxed string

\$15.00

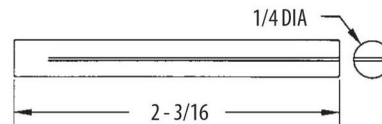

Q128 Field Sandpaper Chuck RH
 • For "Field" abrasive spiral rolls

\$15.00

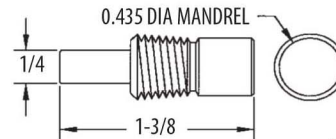

Q127 Field Sandpaper Chuck LH
 • For use on the left side of the lathe

\$15.00

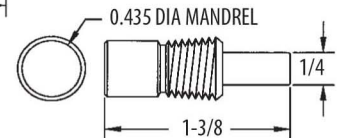

Q198 Field Sandpaper Chuck Long RH
 • For "Field" abrasive spiral rolls

\$15.00

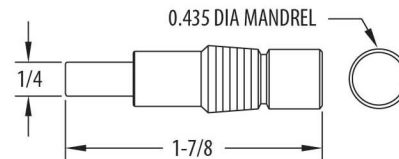

Q197 Field Sandpaper Chuck Long LH
 • For use on the left side of the lathe

\$15.00

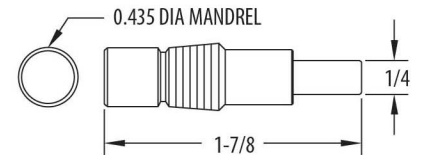

Q118 Arbor - Yates Burr
 • For "Yates" high speed steel burrs.

\$15.00

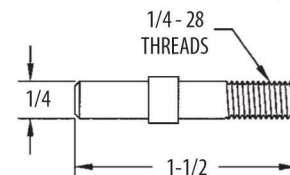

Replacement parts for these accessories are available. See the Quick Chuck User's Manual for part numbers or call us for assistance.

POLISHING LATHES

R051



R051 (Shown)

\$959.00

Baldor 380T Lathe 1/3 Hp

- "Heavy Duty" laboratory polishing lathe
 - Two Speeds, 1725 and 3450 rpm
 - 1/3 Hp, 115 Volt, 60 Hz, 1 phase motor
 - Standard Jeweler's taper (1/4" per ft.) with chuck ejector on both ends
- The 1/3 hp lathe is also available in 100 or 230 volts
Shipped from manufacturer NON-RETURNABLE*

R054 (Not Shown)

\$829.00

Baldor 340 Lathe 1/4 Hp

- "Light Duty" laboratory polishing lathe
 - Two Speeds, 1800 and 3600 rpm
 - 1/4 Hp, 115 Volt, 60 Hz, 1 phase motor
 - Standard Jeweler's taper (1/4" per ft.) with chuck ejector on both ends
- Shipped from manufacturer NON-RETURNABLE*

LATHE ACCESSORIES

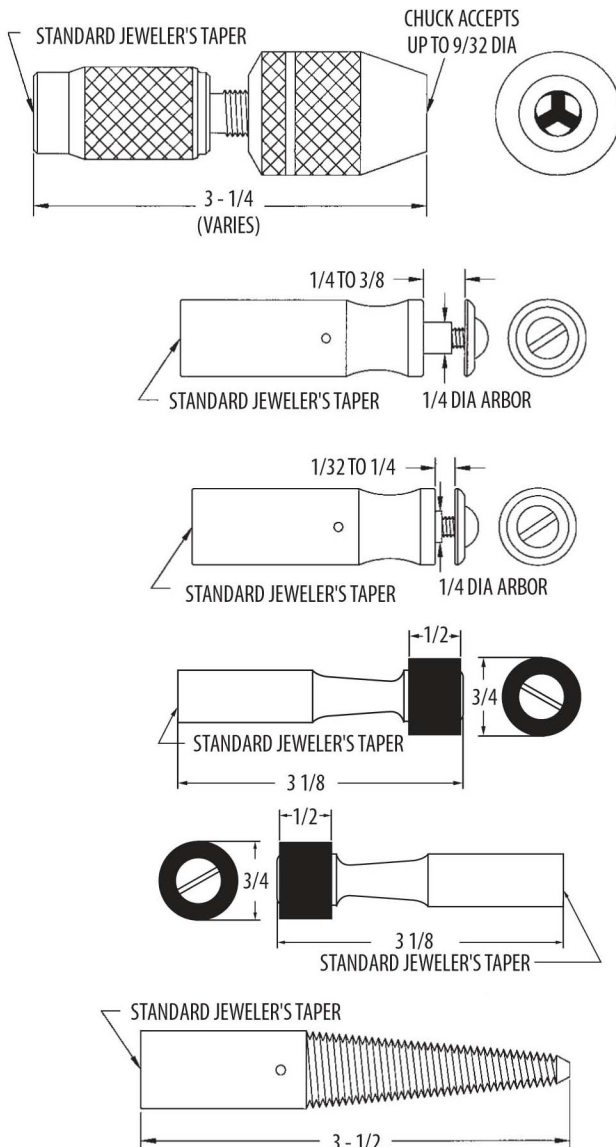

See pages 23-36 for consumables

R131

- 3 Jaw Chuck RH
- For tools with up to 9/32" (7mm) shank
 - For use on the right side of the lathe

\$69.00

R130

- 3 Jaw Chuck LH
- For tools with up to 9/32" (7mm) shank
 - For use on the left side of the lathe

\$69.00

R133

- Stone Chuck Taper Shaft RH
- For wheels and stones 1/4" to 3/8" thick
 - 1/4" dia. arbor

\$15.00

R132

- Stone Chuck Taper Shaft LH
- For use on the left side of the lathe

\$15.00

R135

- Thin Econo Taper Shaft RH
- For Econo Cutters, wheels and stones from 1/32" to 1/4" thick
 - 1/4" dia. arbor

\$15.00

R134

- Thin Econo Taper Shaft LH
- For use on the left side of the lathe

\$15.00

R148

- Arbor Band Taper Shaft 3/4 RH
- Expanding drum for 3/4 dia. abrasive bands

\$15.00

R147

- Arbor Band Taper Shaft 3/4 LH
- For use on the left side of the lathe

\$15.00

R137

- Spiral Taper Shaft RH Stainless Steel
- For brushes and buffs

\$15.00

R136

- Spiral Taper Shaft LH Stainless Steel
- For use on the left side of the lathe.

\$15.00

R139

- Spiral Brass Taper Shaft RH
- Solid brass for brushes and buffs

\$18.00

R138

- Spiral Brass Taper Shaft LH
- For use on the left side of the lathe

\$18.00

SUPER QUICK CHUCK ADAPTORS

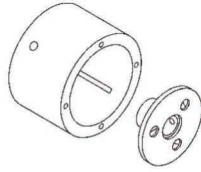

- Q206** Adapter Red Wing
 • Fits all Red Wing Lathes

\$77.00

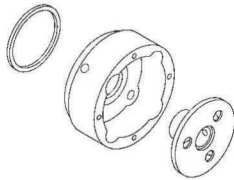

- Q212** Adapter Baldor 210/211/221/240
 • Fits Baldor 210 and 211 Lathes with 35mm or 40mm bearing.
 • Fits Baldor 221 and 240 Lathes with 35mm or 40mm bearing.
 • Q508 adapter ring 40mm is included for lathes with 40mm bearings.
 Note: Fits lathes with removable chuck ejector assembly (see figure A).

\$77.00

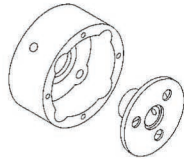

- Q218** Adapter Baldor 300 Series
 • Fits Baldor 350, 353, 357, 359, 370, 380, and 350T & 353T if it has the end plate illustrated in Figure A with a removable chuck ejector assembly

\$77.00

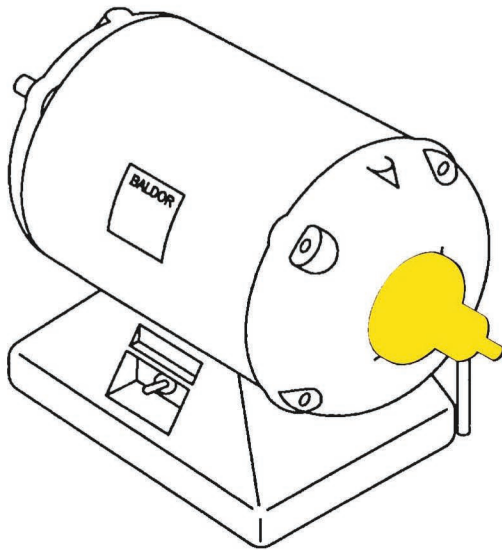

FIGURE A

Lathe Condition:

The lathe should be in good running condition. If it has noisy bearings, a worn switch, starting problems or excessive end play (greater than 1/32"), the condition should be corrected before proceeding with the installation. The condition of the tapered shaft is not important because it is not used.

SUPER QUICK CHUCK ADAPTORS

Q223 Adapter Robbins & Myers
 • Fits Robbins and Myers Lathe

\$113.00

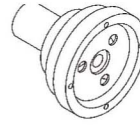

Q226 Adapter Ritter A
 • Fits Ritter model A

\$113.00

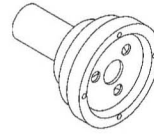

Q229 Adapter Ritter C
 • Fits Ritter model C

\$113.00

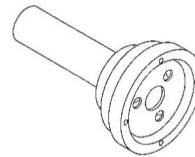

Q237 Adapter Baldor end plate
 • Fits Baldor 357T, 359T, 380T, Wells R051, R052, R053 and Baldor 350T & 353T if it has the end plate illustrated in Figure B where the chuck ejector screws directly into the end plate.

\$180.00

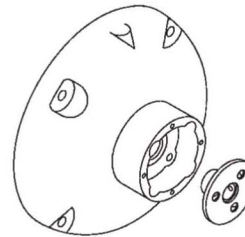

Q239 Adapter Baldor 340 end plate
 • Fits Baldor 340 only

\$180.00

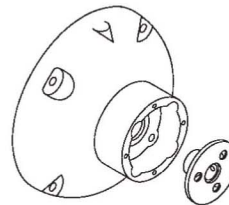

To Order Adapter

Please have the lathe manufacturer's name, model number, catalog number, serial number and spec. number from the lathe name plate to help determine the correct adapter.

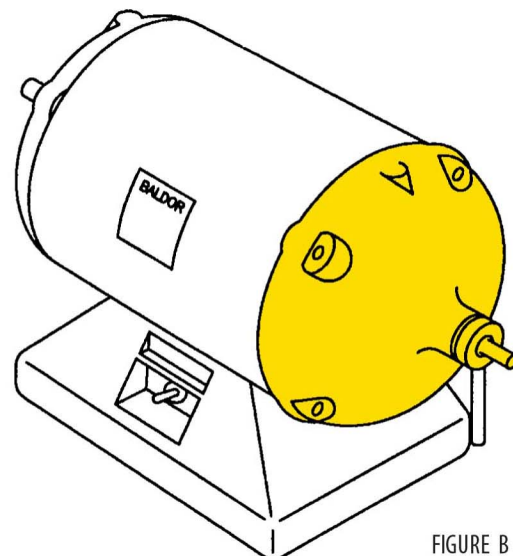
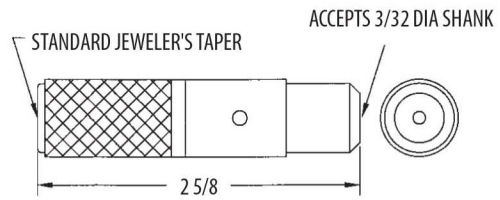

FIGURE B

LATHE ACCESSORIES

- P011** Precision Chuck 3/8" taper **\$105.00**
- Quick change burr chuck
 - For tools with 3/32" dia shank
 - Tools may be changed while lathe is running
 - Fits standard jeweler's taper shaft



- P012** Precision Chuck 1/4 Shaft **\$105.00**
- Quick change burr chuck
 - For tools with 3/32" dia shank
 - Tools may be changed while lathe is running
 - Fits any chuck that accepts a 1/4" dia. shaft

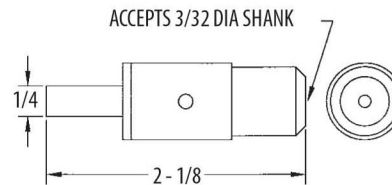

- R142** Shaft Guard RH /Wells/B **\$28.00**
- Fits Wells and Baldor polishing lathes
 - Covers the shaft on the right side of the lathe
 - Identified by one groove on its exterior

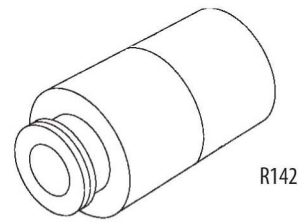

- R141** Shaft Guard LH/Wells/B **\$28.00**
- Fits Wells and Baldor polishing lathes
 - Covers the shaft on the left side of the lathe
 - Identified by three grooves on its exterior

- R144** Shaft Guard RH/RW#2 **\$28.00**
- Fits Red Wing lathe with one piece chuck remover
 - Covers the shaft on the right side of the lathe
 - Shaft guard is male threaded
 - Identified by two grooves on its exterior

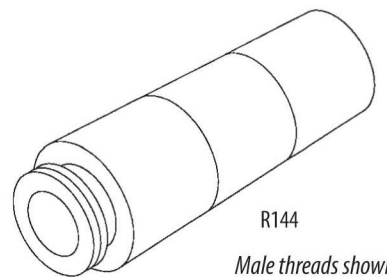

- R143** Shaft Guard LH/RW#2 **\$28.00**
- Fits Red Wing lathe with one piece chuck remover
 - Covers the shaft on the left side of the lathe
 - Shaft guard is male threaded
 - Identified by five grooves on its exterior

- R146** Shaft Guard RH/RW#1 **\$28.00**
- Fits Red Wing lathe with two piece chuck remover
 - Covers the shaft on the right side of the lathe
 - Shaft guard is female threaded
 - Identified by two grooves on its exterior

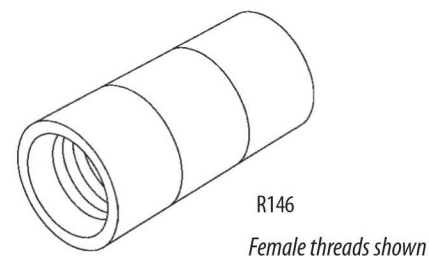

- R145** Shaft Guard LH/RW#1 **\$28.00**
- Fits Red Wing lathe with two piece chuck remover
 - Covers the shaft on the left side of the lathe.
 - Shaft guard is female threaded
 - Identified by three grooves on its exterior

The Shaft Guard satisfies OSHA regulations for covering rotating shafts.

BURRS

Our principle is to provide the optimum solution in terms of quality and cost. One of our solutions is the TN-Titanium Nitride coated carbide burr. These TN coated carbide burrs last at least three times long as uncoated burrs before resharpening. All our carbide burrs are available with TN Coating.



UC-SA-61-A
TN-SA-61-A
UC-SF-61
TN-SF-61
UC-SA-61
TN-SA-61
UC-SG-61
TN-SG-61
UC-SC-61
TN-SC-61
UC-SM-61
TN-SM-61
UC-SN-61
TN-SN-61
UC-SD-61
TN-SD-61
UC-SE-61
TN-SE-61



UC-53D
TN-53D
UC-51A
TN-51A
UC-61-81A
TN-61-81A
UC-73C
TN-73C
UC-88A
TN-88A
UC-83E
TN-83E

		UNCOATED	COATED
UC-SA-61-A	Burr (diamond cut)	\$19.00	
TN-SA-61-A	Burr (diamond cut)		\$22.00
UC-SF-61	Burr (diamond cut)	\$19.00	
TN-SF-61	Burr (diamond cut)		\$22.00
UC-SA-61	Burr (diamond cut)	\$19.00	
TN-SA-61	Burr (diamond cut)		\$22.00
UC-SG-61	Burr (diamond cut)	\$19.00	
TN-SG-61	Burr (diamond cut)		\$22.00
UC-SC-61	Burr (diamond cut)	\$19.00	
TN-SC-61	Burr (diamond cut)		\$22.00
UC-SM-61	Burr (diamond cut)	\$19.00	
TN-SM-61	Burr (diamond cut)		\$22.00
UC-SN-61	Burr (diamond cut)	\$19.00	
TN-SN-61	Burr (diamond cut)		\$22.00
UC-SD-61	Burr (diamond cut)	\$19.00	
TN-SD-61	Burr (diamond cut)		\$22.00
UC-SE-61	Burr (diamond cut)	\$19.00	
TN-SE-61	Burr (diamond cut)		\$22.00
UC-53D	Burr (regular cut 3/16" Ball)	NA	
TN-53D	Burr (regular cut 3/16" Ball)		\$28.00
UC-51A	Burr (regular cut)	\$23.00	
TN-51A	Burr (regular cut)		\$28.00
UC-61-81A	Burr (regular cut)	\$23.00	
TN-61-81A	Burr (regular cut)		\$28.00
UC-73C	Burr (regular cut)	\$23.00	
TN-73C	Burr (regular cut)		\$28.00
UC-88A	Burr (regular cut)	\$23.00	
TN-88A	Burr (regular cut)		\$28.00
UC-83E	Burr (regular cut)	\$23.00	
TN-83E	Burr (regular cut)		\$28.00

BURRS

Lasts THREE times longer.

	UNCOATED	COATED
UC-84-T Burr (regular cut)	NA	
TN-84-T Burr (regular cut)		\$28.00
UC-84-T/LH Burr (regular cut, left hand)	\$29.00	
TN-84-T/LH Burr (regular cut, left hand)		\$34.00
UC-84-T/XC Burr (extra coarse cut)	NA	
TN-84-T/XC Burr (extra coarse cut)		\$28.00
UC-84-T/XF Burr (extra fine cut)	NA	
TN-84-T/XF Burr (extra fine cut)		\$28.00
UC-82-T Burr (regular cut)	\$23.00	
TN-82-T Burr (regular cut)		\$28.00
UC-82-T/XC Burr (extra coarse cut)	\$23.00	
TN-82-T/XC Burr (extra coarse cut)		\$28.00
UC-82-T/XF Burr (extra fine cut)	\$23.00	
TN-82-T/XF Burr (extra fine cut)		\$28.00
UC-63-B Burr (regular cut)	\$23.00	
TN-63-B Burr (regular cut)		\$28.00
UC-63-B/XC Burr (extra coarse cut)	\$23.00	
TN-63-B/XC Burr (extra coarse cut)		\$28.00
UC-63-B/XF Burr (extra fine cut)	\$23.00	
TN-63-B/XF Burr (extra fine cut)		\$28.00
UC-53-A Burr (regular cut)	NA	
TN-53-A Burr (regular cut)		\$28.00
UC-53-A/XC Burr (extra coarse cut)	\$23.00	
TN-53-A/XC Burr (extra coarse cut)		\$28.00
UC-53-A/XF Burr (extra fine cut)	\$23.00	
TN-53-A/XF Burr (extra fine cut)		\$28.00
UC-52-D Burr (regular cut, 1/4" Ball)	NA	
TN-52-D Burr (regular cut, 1/4" Ball)		\$28.00
UC-52-D/XC Burr (extra coarse cut, 1/4" Ball)	NA	
TN-52-D/XC Burr (extra coarse cut, 1/4" Ball)		\$28.00
UC-52-D/XF Burr (extra fine cut, 1/4" Ball)	\$23.00	
TN-52-D/XF Burr (extra fine cut, 1/4" Ball)		\$28.00
UC-52-C Burr (regular cut)	\$23.00	
TN-52-C Burr (regular cut)		\$28.00
UC-52-C/XC Burr (extra coarse cut)	\$23.00	
TN-52-C/XC Burr (extra coarse cut)		\$28.00
UC-52-C/XF Burr (extra fine cut)	\$23.00	
TN-52-C/XF Burr (extra fine cut)		\$28.00
UC-47-XF Burr (extra fine cut)	\$23.00	
TN-47-XF Burr (extra fine cut)		\$28.00
UC-47-XC Burr (extra coarse cut)	\$23.00	
TN-47-XC Burr (extra coarse cut)		\$28.00



Lasts **THREE** times longer.

BURRS



UC-41P UC-44C UC-31P UC-32P UC-33C UC-71G
TN-41P TN-44C TN-31P TN-32P TN-33C TN-71G

TOP VIEW



UC-88-A-4 UC-88-C-4 UC-88-T-4
TN-88-A-4 TN-88-C-4 TN-88-T-4
UC-88-B-4
TN-88-B-4



UC-A3/8 UC-A3/8 LH TN-A3/8 LH left hand UC-B3/8 UC-B3/8 DIA TN-B3/8 DIA UC-C3/8 UC-D3/8 UC-D3/8 LH TN-D3/8 LH left hand UC-E3/8 UC-F3/8 TN-E3/8 TN-F3/8

Diamond Cut

	UNCOATED	COATED
UC-41P Burr (diamond cut)	\$19.00	
TN-41P Burr (diamond cut)		\$22.00
UC-44C Burr (diamond cut)	\$19.00	
TN-44C Burr (diamond cut)		\$22.00
UC-31P Burr (diamond cut)	NA	
TN-31P Burr (diamond cut)		\$22.00
UC-32P Burr (diamond cut)	\$19.00	
TN-32P Burr (diamond cut)		\$22.00
UC-33C Burr (diamond cut)	\$19.00	
TN-33C Burr (diamond cut)		\$22.00
UC-71G Burr (diamond cut)	\$19.00	
TN-71G Burr (diamond cut)		\$22.00
UC-88-A-4 Burr (regular cut)	\$22.00	
TN-88-A-4 Burr (regular cut)		\$29.00
UC-88-B-4 Burr (regular cut, end cut)	\$22.00	
TN-88-B-4 Burr (regular cut, end cut)		\$29.00
UC-88-C-4 Burr (regular cut)	\$22.00	
TN-88-C-4 Burr (regular cut)		\$29.00
UC-88-T-4 Burr (regular cut)	NA	
TN-88-T-4 Burr (regular cut)		\$29.00
UC-A3/8 Burr (regular cut)	NA	
TN-A3/8 Burr (regular cut)		\$55.00
UC-A3/8 LH Burr (regular cut, left hand)	NA	
TN-A3/8 LH Burr (regular cut, left hand)		\$64.00
UC-B3/8 Burr (regular cut)	\$46.00	
TN-B3/8 Burr (regular cut)		\$55.00
UC-B3/8 DIA Burr (diamond cut)	\$46.00	
TN-B3/8 DIA Burr (diamond cut)		\$55.00
UC-C3/8 Burr (regular cut)	\$46.00	
TN-C3/8 Burr (regular cut)		\$55.00
UC-D3/8 Burr (regular cut)	\$46.00	
TN-D3/8 Burr (regular cut)		\$55.00
UC-D3/8 LH Burr (regular cut, left hand)	\$55.00	
TN-D3/8 LH Burr (regular cut, left hand)		\$64.00
UC-E3/8 Burr (regular cut)	\$46.00	
TN-E3/8 Burr (regular cut)		\$55.00
UC-F3/8 Burr (regular cut)	\$46.00	
TN-F3/8 Burr (regular cut)		\$55.00

CONSUMABLES

BURRS

For gross removal of plaster

UC-84-T/SP	Burr (alum cut)
TN-84-T/SP	Burr (alum cut)
UC-88-A/SP	Burr (alum cut)
TN-88-A/SP	Burr (alum cut)
UC-A3/8 SP	Burr (alum cut)
TN-A3/8 SP	Burr (alum cut)
UC-A1/2 SP	Burr (alum cut)
TN-A1/2 SP	Burr (alum cut)
UC-A1/2	Burr (regular cut)
TN-A1/2	Burr (regular cut)
UC-A1/2 LH	Burr (regular cut, left hand)
TN-A1/2 LH	Burr (regular cut, left hand)
UC-B1/2	Burr (regular cut)
TN-B1/2	Burr (regular cut)
UC-B1/2DIA	Burr (diamond cut)
TN-B1/2DIA	Burr (diamond cut)
UC-C1/2	Burr (regular cut)
TN-C1/2	Burr (regular cut)
UC-D1/2	Burr (regular cut)
TN-D1/2	Burr (regular cut)
UC-D1/2 LH	Burr (regular cut, left hand)
TN-D1/2 LH	Burr (regular cut, left hand)
UC-E1/2	Burr (regular cut)
TN-E1/2	Burr (regular cut)
UC-F1/2	Burr (regular cut)
TN-F1/2	Burr (regular cut)

UNCOATED	COATED
\$31.00	\$36.00
\$31.00	\$36.00
\$54.00	\$64.00
\$69.00	\$82.00
\$58.00	\$70.00
NA	\$82.00
\$58.00	\$70.00
\$60.00	\$73.00
\$58.00	\$70.00
NA	\$70.00
\$70.00	\$82.00
NA	
\$70.00	\$70.00
\$58.00	\$70.00



UC-84-T/SP **UC-88-A/SP** **UC-A3/8 SP** **UC-A1/2 SP**
TN-84-T/SP **TN-88-A/SP** **TN-A3/8 SP** **TN-A1/2 SP**



UC-A1/2 **UC-A1/2 LH** **UC-B1/2** **UC-B1/2 DIA** **UC-C1/2** **UC-D1/2** **UC-D1/2 LH** **UC-E1/2** **UC-F1/2**
TN-A1/2 **TN-A1/2 LH** **TN-B1/2** **TN-B1/2 DIA** **TN-C1/2** **TN-D1/2** **TN-D1/2 LH** **TN-E1/2** **TN-F1/2**
left hand **left hand**

Diamond Cut

MODEL TRIMMER WHEELS

Model Trimmer Wheels for Ray Foster model trimmers as well as other brands.

- 10" Diameter
- 1" Hole
- 5/8" Drive Hole

C16TB	Model Trimmer Wheel (Coarse)	\$29.00 each
C20TB	Model Trimmer Wheel (Medium Coarse)	\$29.00 each
C30TB	Model Trimmer Wheel (Fine)	\$29.00 each
C60TB	Model Trimmer Wheel (Extra Fine)	\$29.00 each



ECONO CUTTERS

See pages 21 & 25 for thin econo cutter stone chucks.

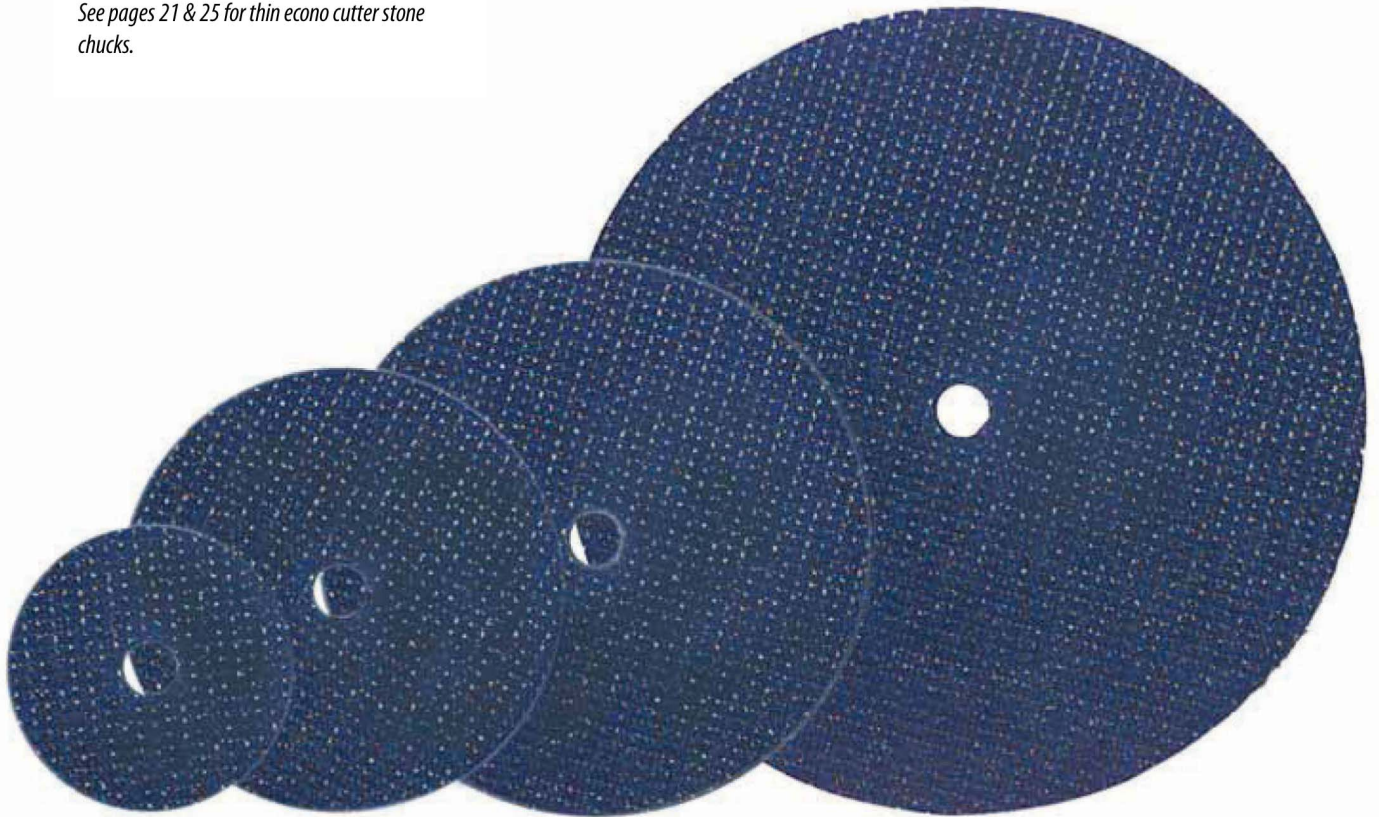

EC675
1 1/2" x 1/32 x 1/4"
\$29.00/12

EC676
2 1/2" x 1/32 x 1/4"
\$18.00/6

EC677
3" x 1/32 x 1/4"
\$19.00/6

EC678
4" x 1/32 x 1/4"
\$32.00/6

ALUMINUM OXIDE ROUGHING DISCS

Pure aluminum oxide disc, non-contaminating, long-lasting, very fast cutting, and odorless.



RD620
35mm x 1.7mm
\$36.50/100



RD621
32mm x 2.2mm
\$36.50/100



RD622
22mm x 3.5mm
\$36.50/100

KEYSTONE CUT-OFF WHEELS

These Cut-Off Wheels are strong and durable. Made with pure aluminum oxide provide non-contaminating fast free cutting of all metals. The wheels come in a reddish-brown color and have a max of 25,000 rpm.



CW320
1 1/4" x .062"
31.8 x 1.6mm
\$25.00/100



CW310
1 1/2" x .040"
38.8 x 1.1mm
\$25.00/100



CW300
1 1/2" x .025"
38.8 x .63mm
\$25.00/100

SEPARATING DISCS



SD650
7/8" x .009"
22mm x 0.2mm
\$46.25/100



SD651
7/8" x .006"
22mm x 0.15mm
\$46.25/100

FACTORY REPAIR

Our service department assures prompt repairs of all Wells products. We have a one to two day turn around time which will get you back into production quickly. There is no return authorization necessary.

When we receive your equipment for repair it is thoroughly checked for worn or damaged parts. Wells equipment can always be rebuilt to factory specifications with a fully reinstated prorated warranty. Your equipment will come back to you just like new at a significant savings over buying new equipment.

BEFORE YOU SEND YOUR EQUIPMENT FOR REPAIR:

1. Consult the technical bulletin or user's manual that came with your equipment. Problems are often solved by simple maintenance procedures. All technical bulletins and user's manuals can be found on our web site www.wellsdental.com. Simply click on "documents" and click on the appropriate manual.
2. Call our toll-free number 1-800-233-0521 and ask for technical support. Our experience may save you extra work and delay.
3. If the equipment needs service beyond your means, ship it directly to us and we will be happy to repair and return it. No return authorization is necessary. We encourage you to send Wells equipment directly to us.
4. UPS is the only delivery company that comes to our location daily. USPS is another alternative. Other major carriers do not deliver to our rural location. To avoid delays please ship UPS to our street address. If you prefer to use the postal service please mail to our post office box.
5. Ship only Wells products to us with your name, your company name, UPS deliverable shipping address (no P.O. boxes) and phone number along with a brief description of the problem and any special instructions. In order to keep our turn around repair service quick we will not call you with an estimate unless you specifically ask in writing. Maximum repair prices are well under the cost of new equipment. Estimates will take an additional one to two days. If you do not have an account with us, your items will be shipped back to you UPS ground COD. If you would like to avoid COD charges, we encourage you to include in your note your credit card number and expiration date.

EQUIPMENT EXCHANGE

If you cannot be without your equipment for the one or two days it takes us to repair your item our exchange service is available. We can send you a rebuilt item with the understanding that you will return your old item to us. Enclosed with the packing list on top of the box you will find a UPS prepaid RS (return service) label. Simply enclose your old equipment in the same box and affix the prepaid return label. You can give the package to any UPS driver and the package will be returned to us. The equipment exchanged will be invoiced at full retail price which serves as a deposit. Upon receipt of your old item, appropriate credit will be issued for the difference between the retail price and the exchange price. No credit will be issued for exchanges not returned within 30 days of invoice date.

TRADE-IN

We offer a trade-in service for equipment from other manufacturers. If you would like to update to a Wells High Speed Spindle, a Wells Super Quick Chuck or a Wells Handpiece and/or Arm we offer a discount on new equipment.

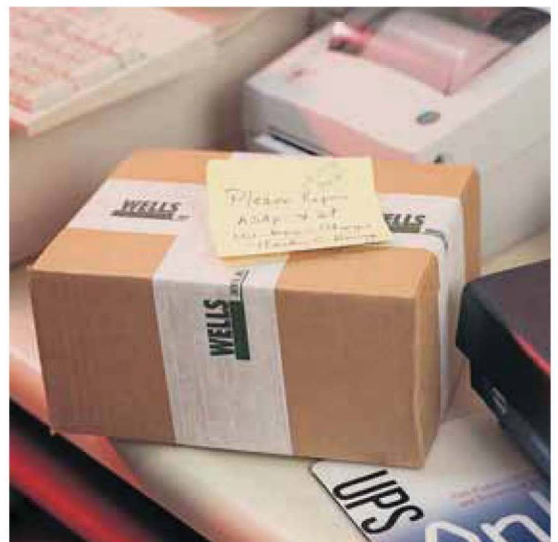
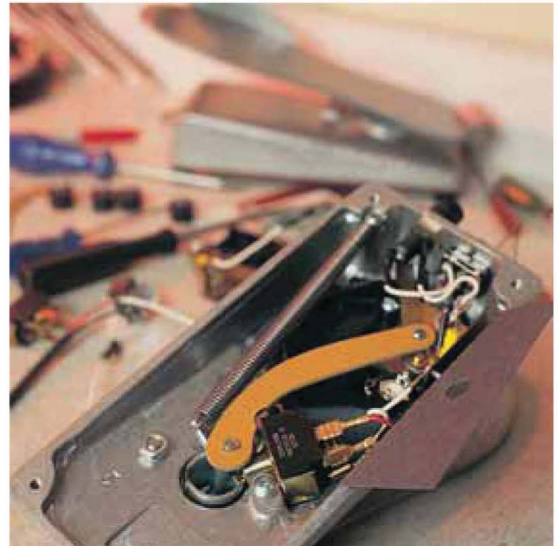

WELLS

DENTAL, INC.



MAILING ADDRESS:

WELLS DENTAL INC
PO BOX 106
COMPTCHE, CA 95427-0106
USA

SHIPPING ADDRESS:

WELLS DENTAL INC
5860 FLYNN CREEK RD
COMPTCHE, CA
95427-9500



TOLL FREE WITHIN U.S.

VOICE 1.800.233.0521

FAX 1.800.809.7553

OUTSIDE U.S.

VOICE 707.937.0521

FAX 707.937.2809

WEB SITE

www.wellsdental.com

BUSINESS HOURS

MON-FRI 8 AM - 4:30 PM
PACIFIC TIME

