

INSTALLATION OF ALUMINUM PULLEYS

Product No. A106 ALUMINUM PULLEY WITH WRENCH

1.0 OVERVIEW

This kit is for replacing pulleys on:

- A011 ENGINE ARM PICCOLO
- A012 ENGINE ARM STANDARD

Do not use this kit for the AS051 or AS052 WHISPER ARM.

2.0 MATERIALS

A106 ALUMINUM PULLEY WITH WRENCH

3.0 FIRST PAIR OF PULLEYS

- 3.1 Unplug the power cord and remove the belt.
- 3.2 Insert a pulley wrench (7/64" diameter rod) into the hole behind the pulley and turn the pulley counterclockwise (as you face the flat side of the pulley). You will have to remove the pulley wrench and insert it into the opposite hole every half turn.
- 3.3 To install a pulley, reverse the procedure of step 3.2. Make sure the pulleys are tight.
- 3.4 Install the belt and connect the power cord.

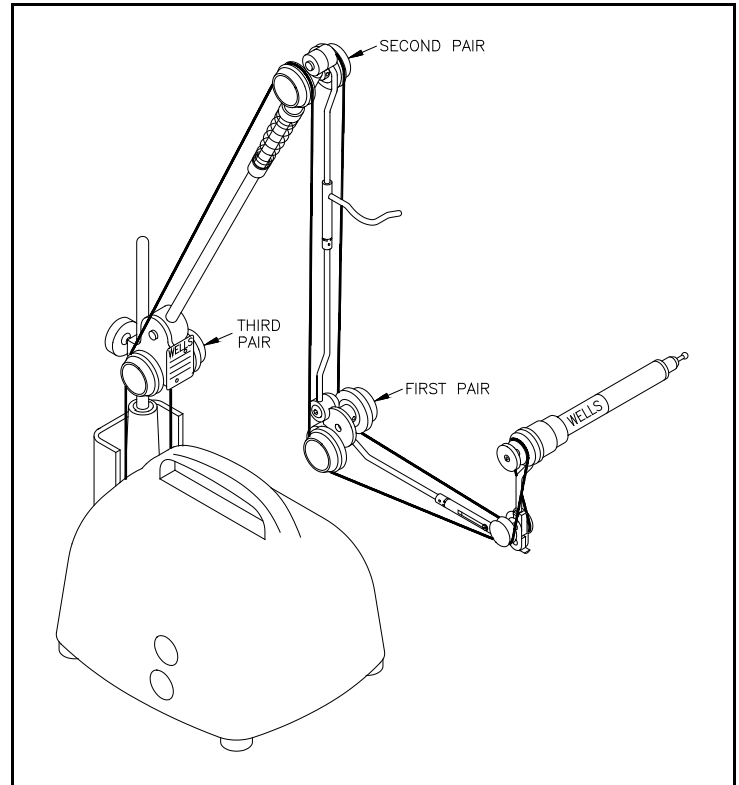

Figure 1.

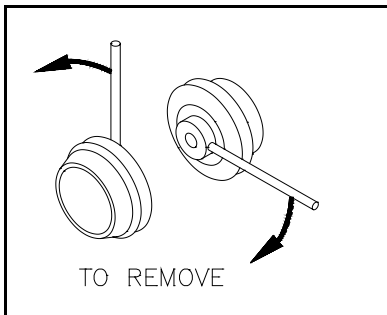

Figure 2.

4.0 SECOND and THIRD PAIR OF PULLEYS

- 4.1 Unplug the power cord and remove the belt.
- 4.2 Insert one pulley wrench (7/64" diameter rod) into the hole behind one pulley. Insert the other pulley wrench into the hole behind the other pulley as a backup wrench. See Figure 2. Turn one pulley counterclockwise (as you face the flat side of the pulley). You will have to remove the pulley wrench and insert it into the opposite hole every half turn.
- 4.3 To install a new pulley, reverse the procedure of step 4.2. Make sure the pulleys are tight.
- 4.4 Install the belt and connect the power cord.